

C.I.P.**358 Norma Mag.**

TAB.

III

Date

84-06-14

Pays d'origine: SE

Révision

02-05-15

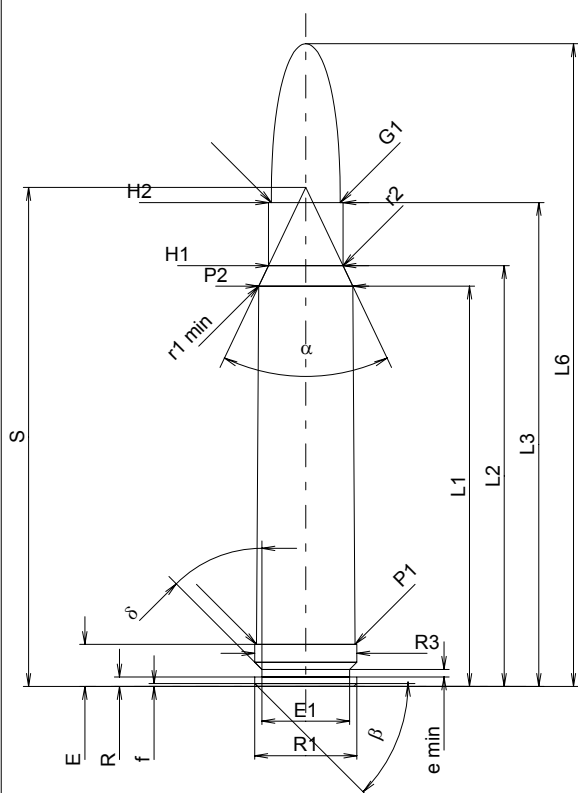
**CARTOUCHE MAXI****Longueurs**

L1	=	52.94
L2	=	55.66
L3 ¹⁾	=	64.00
L4	=	
L5	=	
L6	=	85.00

Culot

R	=	1.25
R1	=	13.50
R3	=	13.50
E ¹⁾	=	5.56
E1	=	11.60
e min	=	1.00
delta	=	45°
f	=	0.40
beta	=	45°

Chambre à poudre

P1	=	13.03
P2*	=	12.45

Cône de raccordement

alpha*	=	51°
S*	=	65.99
r1 min	=	1.00
r2	=	3.00

Collet

H1*	=	9.85
H2 ¹⁾	=	9.85

Projectile

G1 ¹⁾	=	9.12
G2	=	
F	=	
L3+G ¹⁾	=	70.50

Pressions (Énergies)**Méthode transducteur**

Pmax	=	4400 bar
PK	=	5060 bar
PE	=	5500 bar
M	=	25.00
EE	=	4725 Joule

Autres indications

Fe ¹⁾	=	0.10
delta L	=	

CHAMBRE MINI**Longueurs**

L1	=	53.22
L2	=	55.77
L3 ¹⁾	=	64.58

Cuvette

R	=	
R1	=	13.75
R2	=	
R3	=	13.75
r	=	

Chambre à poudre

E ¹⁾	=	5.58
P1 ¹⁾	=	13.06
P2*	=	12.52

Cône de raccordement

alpha*	=	52°
S*	=	66.05
r1 max	=	2.00
r2	=	3.60

Collet

H1*	=	10.03
H2 ¹⁾	=	10.00

Prise de rayures

G1 ¹⁾ *	=	9.14
G ¹⁾	=	6.50
alpha1*	=	90°
h	=	0.43
s	=	
i ¹⁾ *	=	1°10'47"
w	=	

Canon

F ¹⁾ *	=	8.89
Z ¹⁾	=	9.10

Rayures

b	=	3.40
N	=	6
u	=	305.00
Q	=	64.27 mm ²

Échelle 1:1

Dimensions en << mm >>
Dimensions et tolérances pour les canons
d'épreuve: Voyez Annexe CR 1.

Notes: 1) A' contrôler pour la sécurité
* Dimensions de base