

# C.I.P.

# 350 Rem. Mag.

Country of Origin: US

TAB. III

Date 84-06-14

Revision 02-05-15

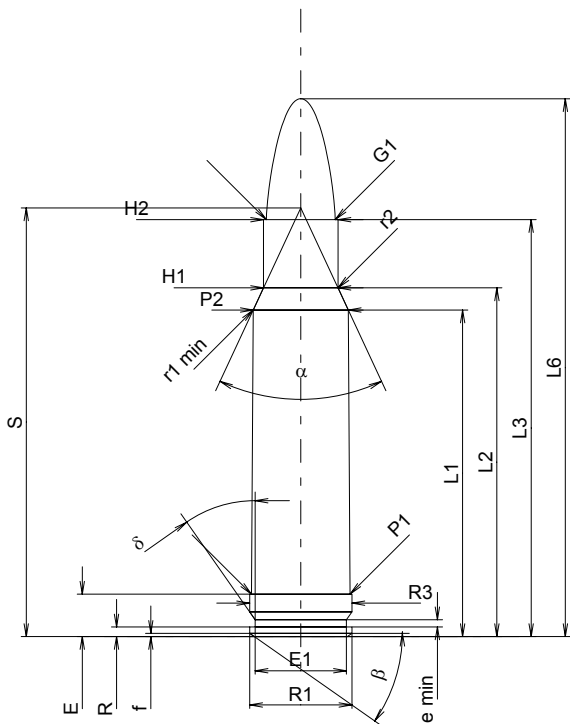

### CARTRIDGE MAXI

#### Lengths

L1	=	43.18
L2	=	46.10
L3 <sup>1)</sup>	=	55.12
L4	=	
L5	=	
L6	=	71.12

#### Case Head

R	=	1.27
R1	=	13.51
R3	=	13.51
E <sup>1)</sup>	=	5.59
E1	=	12.07
e min	=	0.94
delta	=	35°
f	=	0.41
beta	=	35°

#### Powder Chamber

P1	=	13.03
P2*	=	12.58

#### Junction Cone

alpha*	=	50°
S*	=	56.67
r1 min	=	0.76
r2	=	2.54

#### Collar

H1*	=	9.86
H2 <sup>1)</sup>	=	9.86

#### Projectile

G1 <sup>1)</sup>	=	9.12
G2	=	
F	=	
L3+G <sup>1)</sup>	=	64.74

#### Pressures (Energies)

##### Method Transducer

Pmax	=	4300 bar
PK	=	4945 bar
PE	=	5375 bar
M	=	25.00
EE	=	4620 Joule

#### Miscellaneous Dimensions

Fe <sup>1)</sup>	=	0.10
delta L	=	

### CHAMBER MINI

#### Lengths

L1	=	43.39
L2	=	46.27
L3 <sup>1)</sup>	=	55.73

#### Breech

R	=	
R1	=	13.59
R2	=	
R3	=	13.59
r	=	

#### Powder Chamber

E <sup>1)</sup>	=	5.59
P1 <sup>1)</sup>	=	13.06
P2*	=	12.60

#### Junction Cone

alpha*	=	50°
S*	=	56.90
r1 max	=	0.76
r2	=	2.79

#### Collar

H1*	=	9.91
H2 <sup>1)</sup>	=	9.88

#### Commencement of Rifling

G1 <sup>1)*</sup>	=	9.12
G <sup>1)</sup>	=	9.62
alpha1*	=	60°
h	=	0.65
s	=	6.64
j <sup>1)*</sup>	=	2°30'
w	=	

#### Barrel

F <sup>1)*</sup>	=	8.86
Z <sup>1)</sup>	=	9.07

#### Grooves

b	=	3.30
N	=	6
u	=	406.00
Q	=	63.78 mm <sup>2</sup>

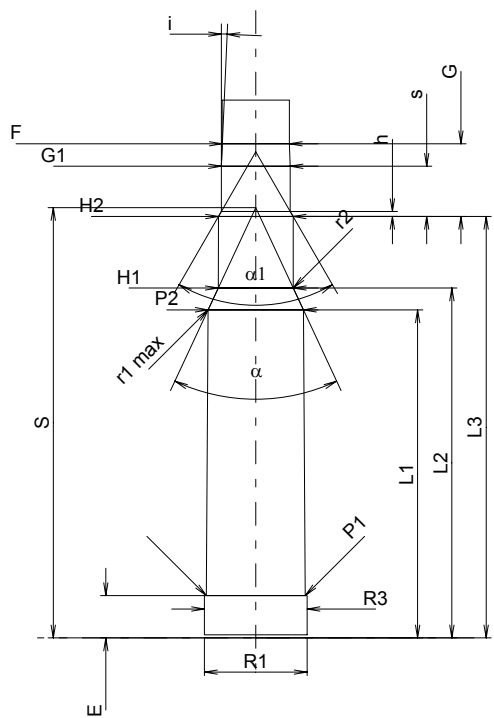

Scale 1:1

Dimensions in << mm >>  
Dimensions and Tolerances for Proof Barrels  
see Appendix CR 1.

Notes: 1) Check for safety reasons  
\* Basic dimensions