

C.I.P.**240 Belt. Riml. N.E.**

TAB. III

Datum 84-06-14

Revision 02-05-15

Ursprungsland: GB

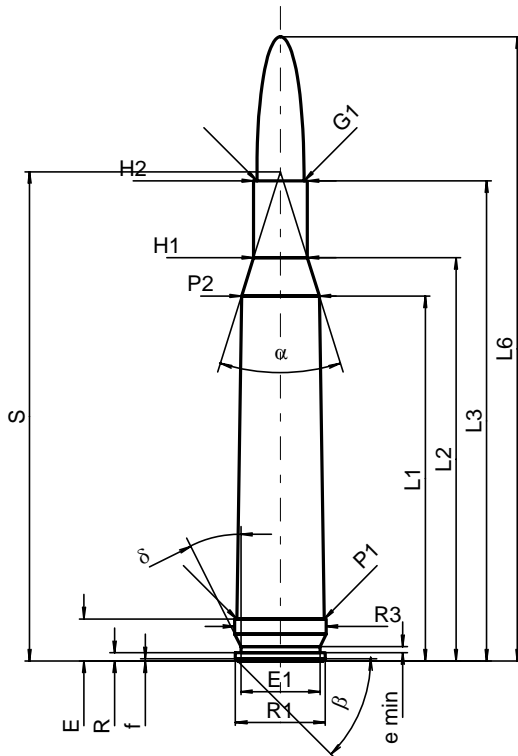
**PATRONE MAXI****Längen**

L1*	=	48.26
L2*	=	53.34
L3 ¹⁾	=	63.50
L4	=	
L5	=	
L6	=	82.55

Hülsenboden

R	=	1.09
R1	=	11.89
R3	=	12.12
E ¹⁾	=	5.56
E1	=	10.46
e min	=	0.81
delta	=	26°34'12"
f	=	0.30
beta	=	45°

Pulverkammer

P1	=	11.56
P2*	=	10.29

Schulterkonus

alpha	=	34°45'34"
S	=	64.70
r1 min	=	
r2	=	

Hülsenhals

H1*	=	7.11
H2 ¹⁾	=	7.11

Geschoss

G1 ¹⁾	=	6.22
G2	=	
F	=	
L3+G ¹⁾	=	68.71

Drücke (Energien)**Mech. elektr. Wandler**

Pmax	=	3300 bar
PK	=	3795 bar
PE	=	4125 bar
M	=	25.00
EE	=	2625 Joule

Verschiedene Daten

Fe ¹⁾	=	0.15
delta L	=	

PATRONENLAGER MINI**Längen**

L1*	=	48.41
L2*	=	53.46
L3 ¹⁾	=	64.00

Stoßboden

R	=	
R1	=	12.17
R2	=	
R3	=	12.17
r	=	

Pulverkammer

E ¹⁾	=	5.56
P1 ¹⁾	=	11.56
P2*	=	10.32

Schulterkonus

alpha	=	34°44'48"
S	=	64.90
r1 max	=	
r2	=	

Hülsenhals

H1*	=	7.16
H2 ¹⁾	=	7.14

Geschossübergang

G1 ¹⁾ *	=	6.27
G ¹⁾ *	=	5.21
alpha1	=	90°
h*	=	0.44
s	=	
i ¹⁾	=	1°30'04"
w	=	

Lauf

F ¹⁾ *	=	6.02
Z ¹⁾	=	6.22

Züge

b	=	3.50
N	=	4
u	=	203.00
Q	=	29.95 mm ²

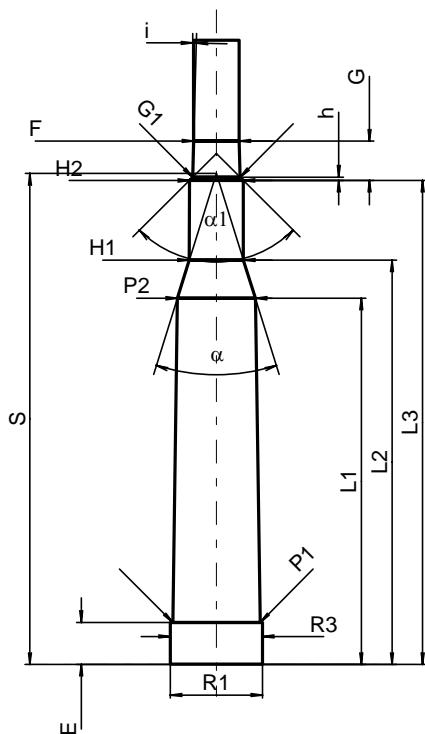

Maßstab 1:1

Maße in << mm >>
Maße und Toleranzen für Messläufe
siehe Anhang CR 1.

Bemerkungen: 1) Kontrolle aus Sicherheitsgründen
* Grundmaße