

C.I.P.**458 Win. Mag.**

TAB. III

Datum 84-06-14

Revision 02-05-15

Ursprungsland: US

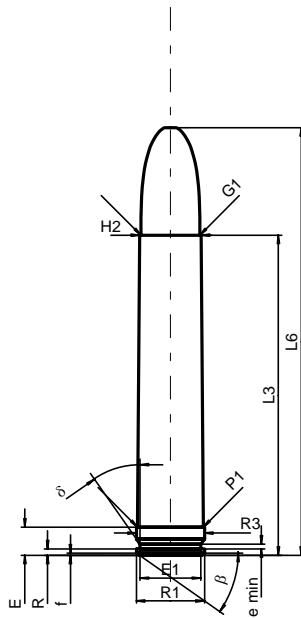
**PATRONE MAXI****Längen**

L1	=	
L2	=	
L3 ¹⁾	=	63.50
L4	=	
L5	=	
L6	=	84.84

Hülsenboden

R	=	1.27
R1	=	13.51
R3	=	13.51
E ¹⁾	=	5.59
E1	=	12.07
e min	=	0.94
delta	=	35°
f	=	0.41
beta	=	35°

Pulverkammer

P1	=	13.03
P2	=	

Schulterkonus

alpha	=	
S	=	
r1 min	=	
r2	=	

Hülsenhals

H1	=	
H2 ¹⁾	=	12.22

Geschoss

G1 ¹⁾	=	11.66
G2	=	
F	=	
L3+G ¹⁾	=	91.65

Drücke (Energien)**Mech. elektr. Wandler**

Pmax	=	4300 bar
PK	=	4945 bar
PE	=	5375 bar
M	=	25.00
EE	=	6615 Joule

Verschiedene Daten

Fe ¹⁾	=	0.10
delta L	=	

PATRONENLAGER MINI**Längen**

L1	=	
L2	=	
L3 ¹⁾	=	64.01

Stoßboden

R	=	
R1	=	13.59
R2	=	
R3	=	13.59
r	=	

Pulverkammer

E ¹⁾	=	5.59
P1 ¹⁾	=	13.08
P2	=	

Schulterkonus

alpha	=	
S	=	
r1 max	=	
r2	=	

Hülsenhals

H1	=	
H2 ¹⁾	=	12.27

Geschossübergang

G1 ^{1)*}	=	11.91
G ¹⁾	=	28.15
alpha1 *	=	90°
h	=	0.18
s	=	
i ^{1)*}	=	0°29'30"
w	=	

Lauf

F ^{1)*}	=	11.43
Z ¹⁾	=	11.63

Züge

b	=	3.81
N	=	6
u	=	356.00
Q	=	104.94 mm ²

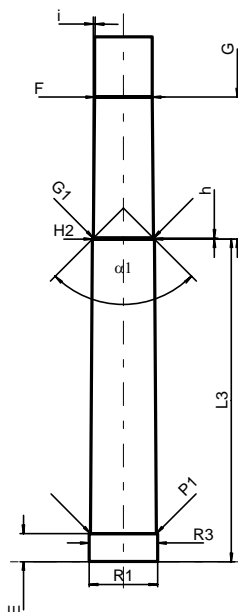

Maßstab 1:1.5

Maße in << mm >>
Maße und Toleranzen für Messläufe
siehe Anhang CR 1.

Bemerkungen: 1) Kontrolle aus Sicherheitsgründen
* Grundmaße