

C.I.P.**45-70 Elko Mag.**

TAB. II

Date 92-07-28

Pays d'origine: BE

Révision 02-05-15

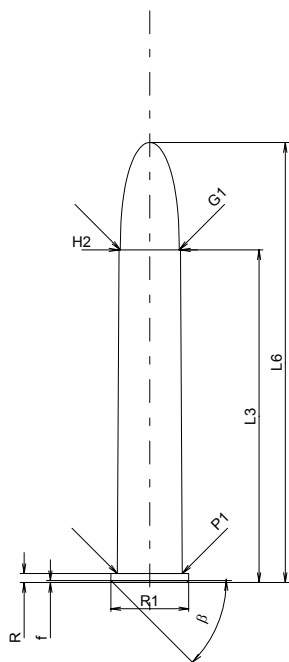
**CARTOUCHE MAXI****Longueurs**

L1	=	
L2	=	
L3 ¹⁾	=	66.00
L4	=	
L5	=	
L6	=	87.30

Colot

R ¹⁾	=	1.78	-0.25
R1	=	15.44	
R3	=		
E	=		
E1	=		
e min	=		
delta	=		
f	=	0.38	
beta	=	45°	

Chambre à poudre

P1	=	12.88
P2	=	

Cône de raccordement

alpha	=	
S	=	
r1 min	=	
r2	=	

Collet

H1	=	
H2 ¹⁾	=	12.22

Projectile

G1 ¹⁾	=	11.66
G2	=	
F	=	
L3+G ¹⁾	=	94.15

Pressions (Énergies)**Méthode transducteur**

Pmax	=	2950 bar
PK	=	3393 bar
PE	=	3690 bar
M	=	25.00
EE	=	6400 Joule

Autres indications

Fe ¹⁾	=	0.15
delta L	=	

CHAMBRE MINI**Longueurs**

L1	=	
L2	=	
L3 ¹⁾	=	66.30

Cuvette

R ¹⁾	=	1.78
R1	=	15.60
R2	=	
R3	=	
r	=	

Chambre à poudre

E	=	
P1 ¹⁾	=	12.91
P2	=	

Cône de raccordement

alpha	=	
S	=	
r1 max	=	
r2	=	

Collet

H1	=	
H2 ¹⁾	=	12.27

Prise de rayures

G1 ¹⁾ *	=	11.91
G ¹⁾ *	=	28.15
alpha1	=	90°
h*	=	0.18
s	=	
i ¹⁾	=	0°29'30"
w	=	

Canon

F ¹⁾ *	=	11.43
Z ¹⁾	=	11.58

Rayures

b	=	3.58
N	=	6
u	=	508.00
Q	=	104.25 mm ²

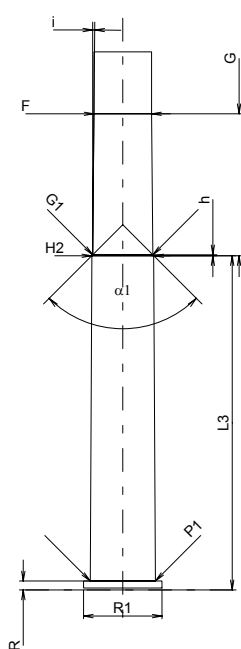

Échelle 1:1.5

Dimensions en << mm >>
Dimensions et tolérances pour les canons
d'épreuve: Voyez Annexe CR 1.

Notes: 1) A' contrôler pour la sécurité
* Dimensions de base