

C.I.P.**360 N.E. 2 "1/4**

TAB. II

Date 84-06-14

Country of Origin: GB

Revision 02-05-15

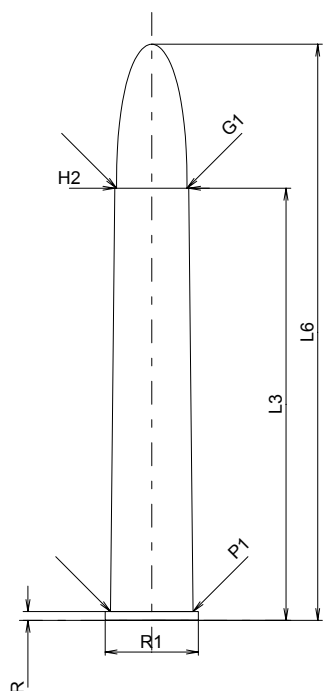
**CARTRIDGE MAXI****Lengths**

L1	=	
L2	=	
L3 ¹⁾	=	57.15
L4	=	
L5	=	
L6	=	76.20

Case Head

R ¹⁾	=	1.17	-0.25
R1	=	12.32	
R3	=		
E	=		
E1	=		
e min	=		
δ	=		
f	=		
β	=		

Powder Chamber

P1	=	10.92
P2	=	

Junction Cone

α	=	
S	=	
r1 min	=	
r2	=	

Collar

H1	=	
H2 ¹⁾	=	9.80

Projectile

G1 ¹⁾	=	9.32
G2	=	
F	=	
L3+G ¹⁾	=	63.83

Pressures (Energies)**Method Transducer**

Pmax	=	2450 bar
PK	=	2818 bar
PE	=	3060 bar
M	=	25.00
EE	=	2285 Joule

Miscellaneous Dimensions

Fe ¹⁾	=	0.15
delta L	=	

CHAMBER MINI**Lengths**

L1	=	
L2	=	
L3 ¹⁾	=	57.40

Breech

R ¹⁾	=	1.19
R1	=	12.57
R2	=	
R3	=	
r	=	

Powder Chamber

E	=	
P1 ¹⁾	=	10.95
P2	=	

Junction Cone

α	=	
S	=	
r1 max	=	
r2	=	

Collar

H1	=	
H2 ¹⁾	=	9.83

Commencement of Rifling

G1 ^{1)*}	=	9.35
G ^{1)*}	=	6.68
$\alpha 1$	=	90°
h [*]	=	0.24
s	=	
i ¹⁾	=	2°00'02"
w	=	

Barrel

F ^{1)*}	=	8.90
Z ¹⁾	=	9.30

Grooves

b	=	
N	=	
u	=	508.00
Q	=	62.21 mm ²

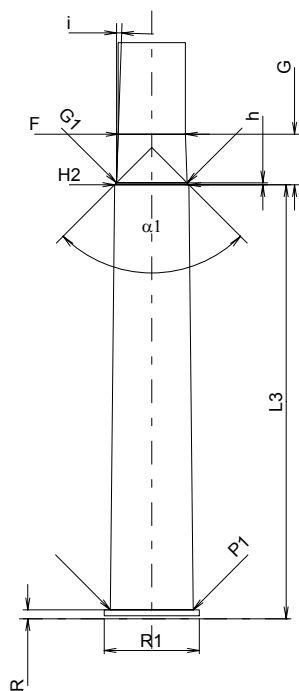

Scale 1:1

Dimensions in << mm >>
Dimensions and Tolerances for Proof Barrels
see Appendix CR 1.

Notes: 1) Check for safety reasons
* Basic dimensions