

C.I.P.

8 x 56 R MPort.Krop.

Country of Origin: PT

TAB. II

Date 84-06-14

Revision 02-05-15

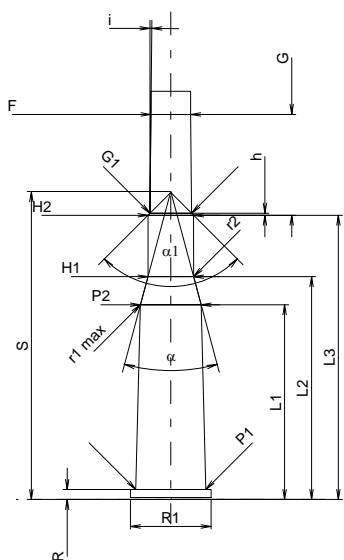
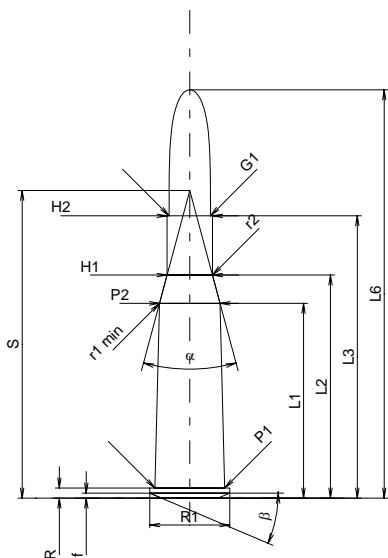

CARTRIDGE MAXI

Lengths

L1	=	38.65
L2	=	44.25
L3 ¹⁾	=	56.00
L4	=	
L5	=	
L6	=	81.00

Case Head

R ¹⁾	=	2.00	-0.25
R1	=	15.90	
R3	=		
E	=		
E1	=		
e min	=		
delta	=		
f	=	1.00	
beta	=	23°	

Powder Chamber

P1	=	13.85
P2 *	=	12.00

Junction Cone

alpha *	=	30°
S *	=	61.04
r1 min	=	10.00
r2	=	15.00

Collar

H1 *	=	9.00
H2 ¹⁾	=	9.00

Projectile

G1 ¹⁾	=	8.20
G2	=	
F	=	
L3+G1 ¹⁾	=	76.00

Pressures (Energies)

Method Transducer

Pmax	=	3400 bar
PK	=	3910 bar
PE	=	4250 bar
M	=	25.00
EE	=	2520 Joule

Miscellaneous Dimensions

Fe ¹⁾	=	0.15
delta L	=	

CHAMBER MINI

Lengths

L1	=	38.65
L2	=	44.21
L3 ¹⁾	=	56.40

Breech

R ¹⁾	=	2.00
R1	=	16.00
R2	=	
R3	=	
r	=	

Powder Chamber

E	=	
P1 ¹⁾	=	13.88
P2 *	=	12.03

Junction Cone

alpha *	=	30°
S *	=	61.10
r1 max	=	10.00
r2	=	15.00

Collar

H1 *	=	9.05
H2 ¹⁾	=	9.03

Commencement of Rifling

G1 ¹⁾ *	=	8.25
G ¹⁾	=	20.00
alpha1 *	=	90°
h	=	0.39
s	=	
i ¹⁾ *	=	0°35'03"
w	=	

Barrel

F ¹⁾ *	=	7.85
Z ¹⁾	=	8.20

Grooves

b	=	4.40
N	=	4
u	=	250.00
Q	=	51.66 mm ²

Scale 1:1.5

Dimensions in << mm >>
Dimensions and Tolerances for Proof Barrels
see Appendix CR 1.

Notes: 1) Check for safety reasons
* Basic dimensions