

C.I.P.

577 Sld. Snider

Country of Origin: GB

TAB. II

Date 84-06-14

Revision 02-05-15

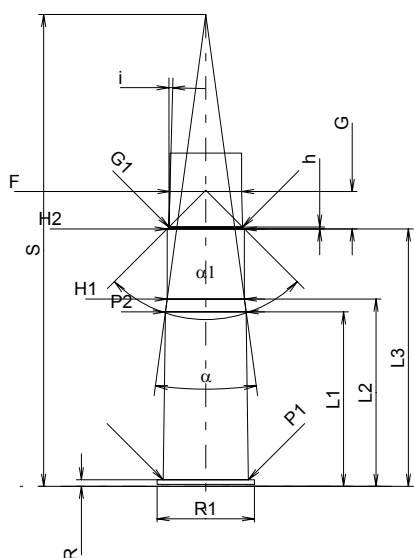
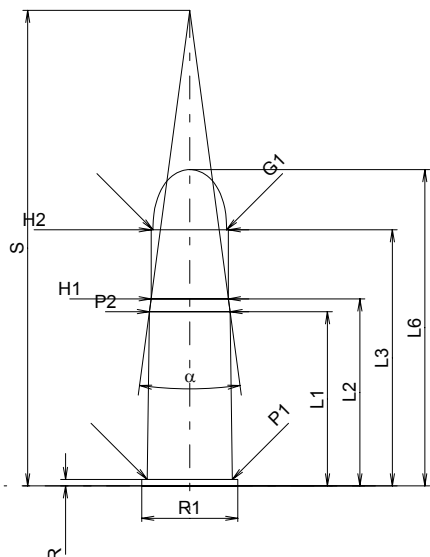

CARTRIDGE MAXI

Lengths

L1*	=	34.57
L2*	=	37.11
L3 ¹⁾	=	50.80
L4	=	
L5	=	
L6	=	62.74

Case Head

R ¹⁾	=	1.27	-0.25
R1	=	19.05	
R3	=		
E	=		
E1	=		
e min	=		
delta	=		
f	=		
beta	=		

Powder Chamber

P1	=	16.89
P2*	=	16.00

Junction Cone

alpha	=	15°14'53"
S	=	94.33
r1 min	=	
r2	=	

Collar

H1*	=	15.32
H2 ¹⁾	=	15.32

Projectile

G1 ¹⁾	=	14.58
G2	=	
F	=	
L3+G ¹⁾	=	58.23

Pressures (Energies)

Method Transducer

Pmax	=	1500 bar
PK	=	1725 bar
PE	=	1875 bar
M	=	25.00
EE	=	2290 Joule

Miscellaneous Dimensions

Fe ¹⁾	=	0.15
delta L	=	

CHAMBER MINI

Lengths

L1*	=	34.59
L2*	=	37.13
L3 ¹⁾	=	51.05

Breech

R ¹⁾	=	1.30
R1	=	19.30
R2	=	
R3	=	
r	=	

Powder Chamber

E	=	
P1 ¹⁾	=	16.92
P2*	=	16.03

Junction Cone

alpha	=	15°28'12"
S	=	93.60
r1 max	=	
r2	=	

Collar

H1*	=	15.34
H2 ¹⁾	=	15.34

Commencement of Rifling

G1 ¹⁾ *	=	14.60
G ¹⁾ *	=	7.43
alpha1	=	90°
h*	=	0.37
s	=	
i ¹⁾	=	1°30'02"
w	=	

Barrel

F ¹⁾ *	=	14.23
Z ¹⁾	=	14.58

Grooves

b	=	
N	=	
u	=	508.00
Q	=	159.04 mm ²

Scale 1:1.5

Dimensions in << mm >>
Dimensions and Tolerances for Proof Barrels
see Appendix CR 1.

Notes: 1) Check for safety reasons
* Basic dimensions