

# C.I.P.

## 56/50 Spencer

Country of Origin: US

TAB.	II
Date	04-05-18
Revision	06-09-19

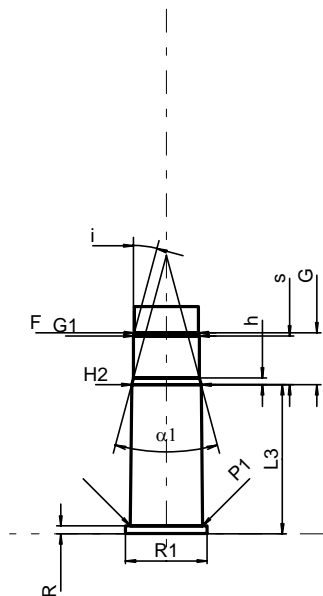
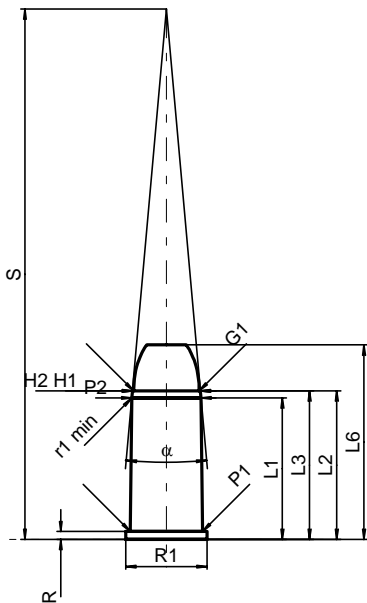

Scale 1:1.5

Dimensions in << mm >>  
Dimensions and Tolerances for Proof Barrels  
see Appendix CR 1.

### CARTRIDGE MAXI

#### Lengths

L1	=	28.04
L2	=	29.44
L3 <sup>1)</sup>	=	29.44
L4	=	
L5	=	
L6	=	38.56

#### Case Head

R <sup>1)</sup>	=	1.55	-0.25
R1	=	16.13	
R3	=		
E	=		
E1	=		
e min	=		
delta	=		
f	=		
beta	=		

#### Powder Chamber

P1	=	14.30
P2 *	=	13.75

#### Junction Cone

alpha *	=	10°11'
S *	=	105.20
r1 min	=	0.50
r2	=	

#### Collar

H1 *	=	13.50
H2 <sup>1)</sup>	=	13.50

#### Projectile

G1 <sup>1)</sup>	=	13.00
G2	=	
F	=	
L1+G <sup>1)</sup>	=	39.76

#### Pressures (Energies)

##### Method Transducer

Pmax	=	2050 bar
PK	=	2358 bar
PE	=	2560 bar
M	=	17.50
EE	=	1950 Joule

#### Miscellaneous Dimensions

Fe	=	0.15
delta L	=	

### CHAMBER MINI

#### Lengths

L1	=	
L2	=	
L3 <sup>1)</sup>	=	29.55

#### Breech

R	=	1.55
R1	=	16.20
R2	=	
R3	=	
r	=	

#### Powder Chamber

E	=	
P1 <sup>1)</sup>	=	14.32
P2	=	

#### Junction Cone

alpha	=	
S	=	
r1 max	=	
r2	=	

#### Collar

H1	=	
H2 <sup>1)</sup>	=	13.77

#### Commencement of Rifling

G1 <sup>1)</sup> *	=	13.03
G <sup>1)</sup>	=	10.32
alpha1 *	=	30°
h	=	1.38
s	=	9.70
i <sup>1)</sup> *	=	15°
w	=	

#### Barrel

F <sup>1)</sup> *	=	12.70
Z <sup>1)</sup>	=	12.95

#### Grooves

b	=	3.50
N	=	6
u	=	508.00
Q	=	129.34 mm <sup>2</sup>

Notes: 1) Check for safety reasons  
\* Basic dimensions