

C.I.P.**45-70 Elko Mag.**

TAB. II

Date 92-07-28

Country of Origin: BE

Revision 02-05-15

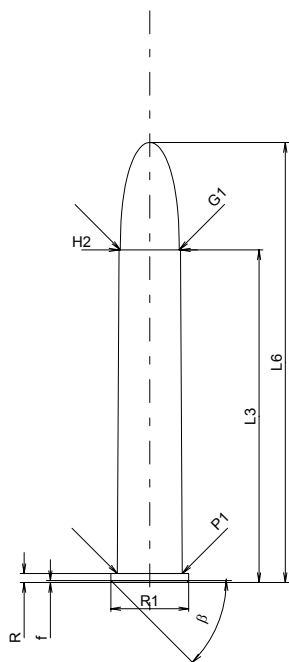
**CARTRIDGE MAXI****Lengths**

L1	=	
L2	=	
L3 ¹⁾	=	66.00
L4	=	
L5	=	
L6	=	87.30

Case Head

R ¹⁾	=	1.78	-0.25
R1	=	15.44	
R3	=		
E	=		
E1	=		
e min	=		
δ	=		
f	=	0.38	
β	=	45°	

Powder Chamber

P1	=	12.88
P2	=	

Junction Cone

α	=	
S	=	
r1 min	=	
r2	=	

Collar

H1	=	
H2 ¹⁾	=	12.22

Projectile

G1 ¹⁾	=	11.66
G2	=	
F	=	
L3+G ¹⁾	=	94.15

Pressures (Energies)**Method Transducer**

Pmax	=	2950 bar
PK	=	3393 bar
PE	=	3690 bar
M	=	25.00
EE	=	6400 Joule

Miscellaneous Dimensions

Fe ¹⁾	=	0.15
delta L	=	

CHAMBER MINI**Lengths**

L1	=	
L2	=	
L3 ¹⁾	=	66.30

Breech

R ¹⁾	=	1.78
R1	=	15.60
R2	=	
R3	=	
r	=	

Powder Chamber

E	=	
P1 ¹⁾	=	12.91
P2	=	

Junction Cone

α	=	
S	=	
r1 max	=	
r2	=	

Collar

H1	=	
H2 ¹⁾	=	12.27

Commencement of Rifling

G1 ^{1)*}	=	11.91
G ^{1)*}	=	28.15
α1	=	90°
h*	=	0.18
s	=	
i ¹⁾	=	0°29'30"
w	=	

Barrel

F ^{1)*}	=	11.43
Z ¹⁾	=	11.58

Grooves

b	=	3.58
N	=	6
u	=	508.00
Q	=	104.25 mm ²

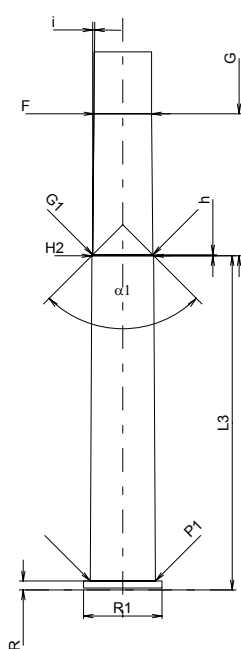

Scale 1:1.5

Dimensions in << mm >>
Dimensions and Tolerances for Proof Barrels
see Appendix CR 1.

Notes: 1) Check for safety reasons
* Basic dimensions