

C.I.P.**360 N.E. 2 "1/4**

Ursprungsland: GB

TAB. II

Datum 84-06-14

Revision 02-05-15

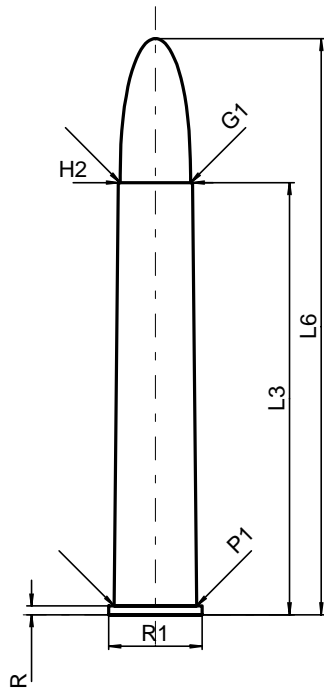
**PATRONE MAXI****Längen**

L1	=	
L2	=	
L3 ¹⁾	=	57.15
L4	=	
L5	=	
L6	=	76.20

Hülsenboden

R ¹⁾	=	1.17	-0.25
R1	=	12.32	
R3	=		
E	=		
E1	=		
e min	=		
δ	=		
f	=		
β	=		

Pulverkammer

P1	=	10.92
P2	=	

Schulterkonus

α	=	
S	=	
r1 min	=	
r2	=	

Hülsenhals

H1	=	
H2 ¹⁾	=	9.80

Geschoss

G1 ¹⁾	=	9.32
G2	=	
F	=	
L3+G ¹⁾	=	63.83

Drücke (Energien)**Mech. elektr. Wandler**

Pmax	=	2450 bar
PK	=	2818 bar
PE	=	3060 bar
M	=	25.00
EE	=	2285 Joule

Verschiedene Daten

Fe ¹⁾	=	0.15
delta L	=	

PATRONENLAGER MINI**Längen**

L1	=	
L2	=	
L3 ¹⁾	=	57.40

Stoßboden

R ¹⁾	=	1.19
R1	=	12.57
R2	=	
R3	=	
r	=	

Pulverkammer

E	=	
P1 ¹⁾	=	10.95
P2	=	

Schulterkonus

α	=	
S	=	
r1 max	=	
r2	=	

Hülsenhals

H1	=	
H2 ¹⁾	=	9.83

Geschossübergang

G1 ^{1)*}	=	9.35
G ^{1)*}	=	6.68
α1	=	90°
h*	=	0.24
s	=	
i ¹⁾	=	2°00'03"
w	=	

Lauf

F ^{1)*}	=	8.90
Z ¹⁾	=	9.30

Züge

b	=	
N	=	
u	=	508.00
Q	=	62.21 mm ²

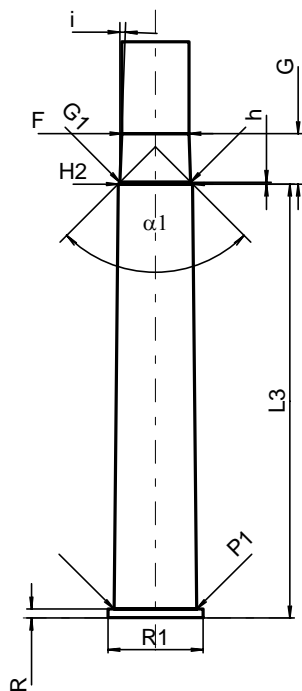

Maßstab 1:1

Maße in << mm >>
Maße und Toleranzen für Messläufe
siehe Anhang CR 1.

Bemerkungen: 1) Kontrolle aus Sicherheitsgründen
* Grundmaße