

C.I.P.**32 Win. SL**

TAB. II

Datum 84-06-14

Revision 02-05-15

Ursprungsland: US

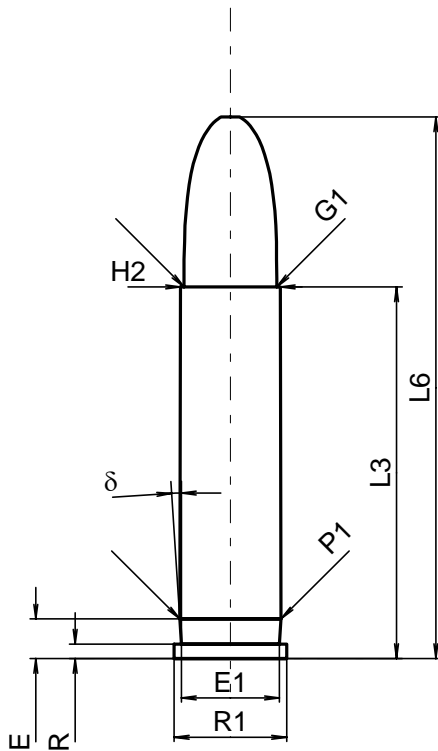
**PATRONE MAXI****Längen**

L1	=	
L2	=	
L3 ¹⁾	=	32.77
L4	=	
L5	=	
L6	=	47.75

Hülsenboden

R ¹⁾	=	1.27	-0.25
R1	=	9.91	
R3	=		
E	=	3.49	
E1	=	8.64	
e min	=		
δ	=	3°44'24"	
f	=		
β	=		

Pulverkammer

P1	=	8.93
P2	=	

Schulterkonus

α	=	
S	=	
r1 min	=	
r2	=	

Hülsenhals

H1	=	
H2 ¹⁾	=	8.81

Geschoss

G1 ¹⁾	=	8.18
G2	=	
F	=	
L3+G ¹⁾	=	42.22

Drücke (Energien)**Mech. elektr. Wandler**

Pmax	=	1550 bar
PK	=	1783 bar
PE	=	1940 bar
M	=	17.50
EE	=	1080 Joule

Verschiedene Daten

Fe ¹⁾	=	0.15
delta L	=	

PATRONENLAGER MINI**Längen**

L1	=	
L2	=	
L3 ¹⁾	=	33.60

Stoßboden

R ¹⁾	=	1.27
R1	=	10.41
R2	=	
R3	=	
r	=	

Pulverkammer

E	=	
P1 ¹⁾	=	9.05
P2	=	

Schulterkonus

α	=	
S	=	
r1 max	=	
r2	=	

Hülsenhals

H1	=	
H2 ¹⁾	=	8.88

Geschossübergang

G1 ^{1)*}	=	8.19
G ¹⁾	=	9.45
α1 [*]	=	180°
h	=	
s	=	
i ^{1)*}	=	0°34'33"
w	=	

Lauf

F ^{1)*}	=	8.00
Z ¹⁾	=	8.13

Züge

b	=	2.51
N	=	6
u	=	406.00
Q	=	51.26 mm ²

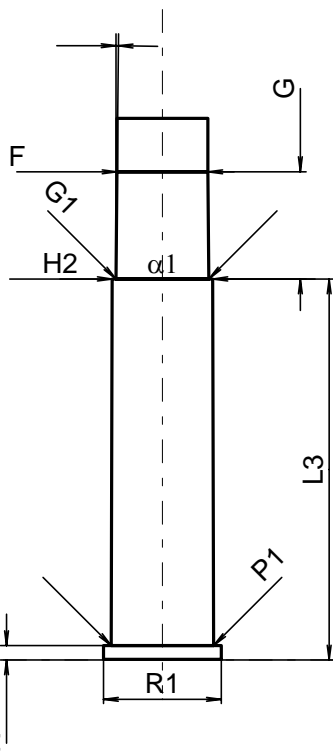

Maßstab 1.5:1

Maße in << mm >>
Maße und Toleranzen für Messläufe
siehe Anhang CR 1.

Bemerkungen: 1) Kontrolle aus Sicherheitsgründen
* Grundmaße