

C.I.P.**300 Sherwood**

TAB. II

Datum 84-06-14

Revision 02-05-15

Ursprungsland: GB

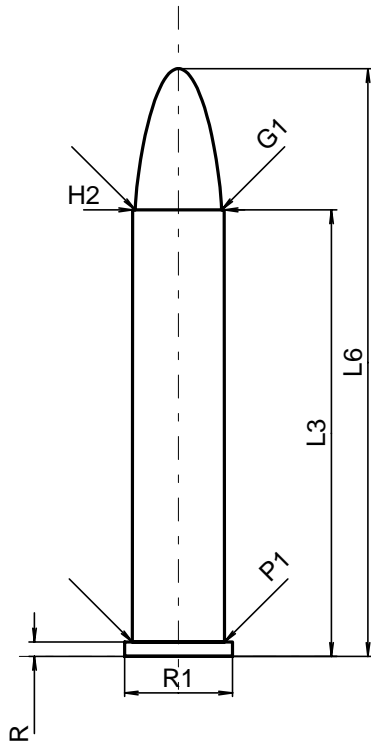
**PATRONE MAXI****Längen**

L1	=	
L2	=	
L3 ¹⁾	=	39.37
L4	=	
L5	=	
L6	=	51.82

Hülsenboden

R ¹⁾	=	1.27	-0.25
R1	=	9.52	
R3	=		
E	=		
E1	=		
e min	=		
δ	=		
f	=		
β	=		

Pulverkammer

P1	=	8.13
P2	=	

Schulterkonus

α	=	
S	=	
r1 min	=	
r2	=	

Hülsenhals

H1	=	
H2 ¹⁾	=	8.08

Geschoss

G1 ¹⁾	=	7.62
G2	=	
F	=	
L3+G ¹⁾	=	43.81

Drücke (Energien)**Mech. elektr. Wandler**

Pmax	=	1400 bar
PK	=	1610 bar
PE	=	1750 bar
M	=	25.00
EE	=	930 Joule

Verschiedene Daten

Fe ¹⁾	=	0.15
delta L	=	

PATRONELAGER MINI**Längen**

L1	=	
L2	=	
L3 ¹⁾	=	39.62

Stoßboden

R ¹⁾	=	1.30
R1	=	9.65
R2	=	
R3	=	
r	=	

Pulverkammer

E	=	
P1 ¹⁾	=	8.15
P2	=	

Schulterkonus

α	=	
S	=	
r1 max	=	
r2	=	

Hülsenhals

H1	=	
H2 ¹⁾	=	8.10

Geschossübergang

G1 ^{1)*}	=	7.62
G ^{1)*}	=	4.44
α1	=	180°
h	=	
s	=	
i ¹⁾	=	1°25'09"
w	=	

Lauf

F ^{1)*}	=	7.40
Z ¹⁾	=	7.62

Züge

b	=	
N	=	
u	=	508.00
Q	=	43.01 mm ²

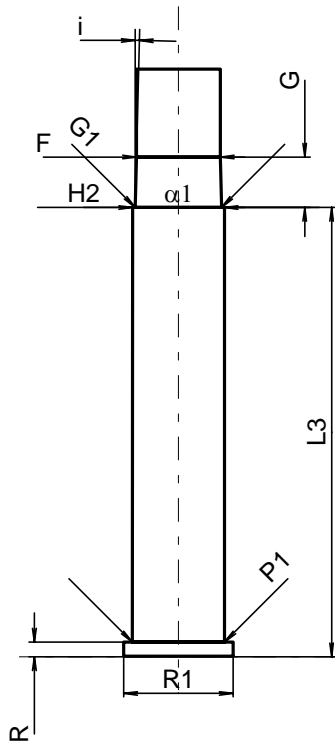

Maßstab 1.5:1

Maße in << mm >>
Maße und Toleranzen für Messläufe
siehe Anhang CR 1.

Bemerkungen: 1) Kontrolle aus Sicherheitsgründen
* Grundmaße