

C.I.P.**8,5 x 63 R**

Ursprungsland: DE

TAB. II

Datum 92-02-27

Revision 06-01-24

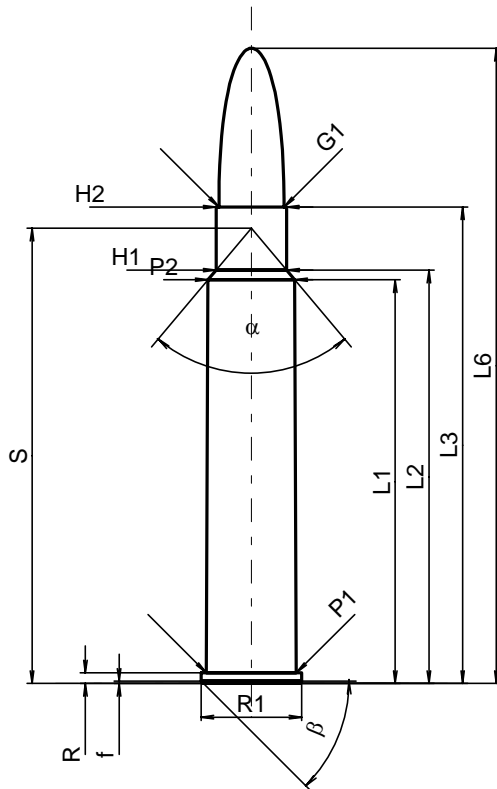
**PATRONE MAXI****Längen**

L1*	=	53.39
L2*	=	54.66
L3 ¹⁾	=	63.00
L4	=	
L5	=	
L6	=	84.00

Hülsenboden

R ¹⁾	=	1.40	-0.25
R1	=	13.32	
R3	=		
E	=		
E1	=		
e min	=		
delta	=		
f	=	0.30	
beta	=	45°	

Pulverkammer

P1	=	11.89
P2*	=	11.47

Schulterkonus

alpha	=	80°13'46"
S	=	60.20
r1 min	=	
r2	=	

Hülsenhals

H1*	=	9.33
H2 ¹⁾	=	9.32

Geschoss

G1 ¹⁾	=	8.59
G2	=	
F	=	
L3+G ¹⁾	=	72.00

Drücke (Energien)**Mech. elektr. Wandler**

Pmax	=	3800 bar
PK	=	4370 bar
PE	=	4750 bar
M	=	25.00
EE	=	5145 Joule

Verschiedene Daten

Fe ¹⁾	=	0.15
delta L	=	

PATRONENLAGER MINI**Längen**

L1*	=	53.40
L2*	=	54.67
L3 ¹⁾	=	63.55

Stoßboden

R ¹⁾	=	1.40
R1	=	13.37
R2	=	
R3	=	
r	=	

Pulverkammer

E	=	
P1 ¹⁾	=	11.92
P2*	=	11.50

Schulterkonus

alpha	=	80°13'46"
S	=	60.22
r1 max	=	
r2	=	

Hülsenhals

H1*	=	9.36
H2 ¹⁾	=	9.35

Geschossübergang

G1 ¹⁾ *	=	8.61
G ¹⁾ *	=	9.00
alpha1	=	180°
h	=	
s*	=	5.83
i ¹⁾	=	1°53'49"
w	=	

Lauf

F ¹⁾ *	=	8.38
Z ¹⁾	=	8.59

Züge

b	=	2.79
N	=	6
u	=	254.00
Q	=	56.95 mm ²

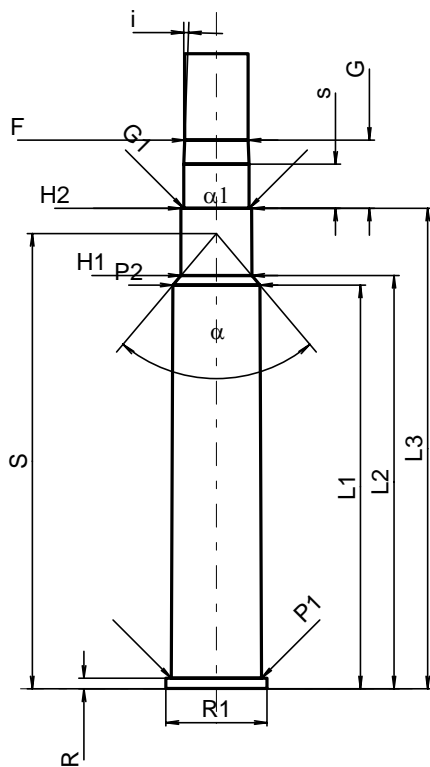

Maßstab 1:1

Maße in << mm >>
Maße und Toleranzen für Messläufe
siehe Anhang CR 1.

Bemerkungen: 1) Kontrolle aus Sicherheitsgründen
* Grundmaße