

**C.I.P.****8 mm - 348 Win.**

TAB. II

Datum 99-03-16

Revision 02-05-15

Ursprungsland: FR

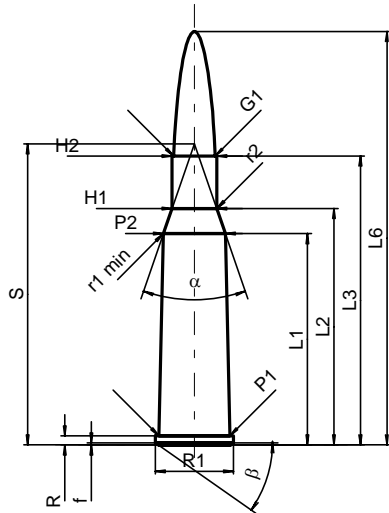
**PATRONE MAXI****Längen**

L1 *	=	41.91
L2 *	=	46.88
L3 <sup>1)</sup>	=	57.28
L4	=	
L5	=	
L6	=	82.00

**Hülsenboden**

R <sup>1)</sup>	=	1.78	-0.25
R1	=	15.49	
R3	=		
E	=		
E1	=		
e min	=		
delta	=		
f	=	0.38	
beta	=	35°	

**Pulverkammer**

P1	=	14.05
P2 *	=	12.32

**Schulterkonus**

alpha	=	38°10'45"
S	=	59.71
r1 min	=	0.76
r2	=	2.54

**Hülsenhals**

H1 *	=	8.88
H2 <sup>1)</sup>	=	8.85

**Geschoss**

G1 <sup>1)</sup>	=	8.22
G2	=	
F	=	
L3+G <sup>1)</sup>	=	66.77

**Drücke (Energien)****Mech. elektr. Wandler**

Pmax	=	3000 bar
PK	=	3450 bar
PE	=	3750 bar
M	=	25.00
EE	=	2600 Joule

**Verschiedene Daten**

Fe <sup>1)</sup>	=	0.15
delta L	=	

**PATRONELAGER MINI****Längen**

L1 *	=	42.17
L2 *	=	47.12
L3 <sup>1)</sup>	=	57.53

**Stoßboden**

R <sup>1)</sup>	=	1.78
R1	=	15.75
R2	=	
R3	=	
r	=	

**Pulverkammer**

E	=	
P1 <sup>1)</sup>	=	14.07
P2 *	=	12.34

**Schulterkonus**

alpha	=	38°19'20"
S	=	59.93
r1 max	=	0.76
r2	=	2.54

**Hülsenhals**

H1 *	=	8.90
H2 <sup>1)</sup>	=	8.87

**Geschossübergang**

G1 <sup>1)</sup> *	=	8.23
G <sup>1)</sup> *	=	9.49
alpha1	=	90°
h	=	0.32
s *	=	3.00
i <sup>1)</sup>	=	1°30'02"
w	=	

**Lauf**

F <sup>1)</sup> *	=	7.89
Z <sup>1)</sup>	=	8.20

**Züge**

b	=	4.05
N	=	4
u	=	240.00
Q	=	51.52 mm <sup>2</sup>

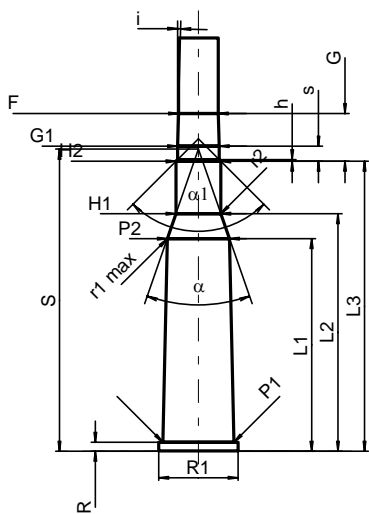

Maßstab 1:1.5

Maße in << mm >>  
Maße und Toleranzen für Messläufe  
siehe Anhang CR 1.

Bemerkungen: 1) Kontrolle aus Sicherheitsgründen  
\* Grundmaße