

C.I.P.**500/465 N.E.**

TAB. II

Datum 84-06-14

Revision 02-05-15

Ursprungsland: GB

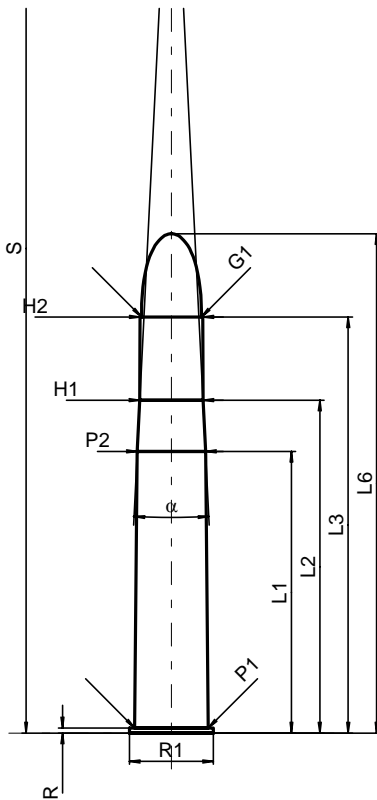
**PATRONE MAXI****Längen**

L1*	=	55.88
L2*	=	66.04
L3 ¹⁾	=	82.55
L4	=	
L5	=	
L6	=	99.06

Hülsenboden

R ¹⁾	=	1.02	-0.25
R1	=	16.64	
R3	=		
E	=		
E1	=		
e min	=		
δ	=		
f	=		
β	=		

Pulverkammer

P1	=	14.58
P2*	=	13.56

Schulterkonus

α	=	5°41'28"
S	=	192.29
r1 min	=	
r2	=	

Hülsenhals

H1*	=	12.55
H2 ¹⁾	=	12.47

Geschoss

G1 ¹⁾	=	11.89
G2	=	
F	=	
L3+G ¹⁾	=	93.15

Drücke (Energien)**Mech. elektr. Wandler**

Pmax	=	2450 bar
PK	=	2818 bar
PE	=	3060 bar
M	=	25.00
EE	=	6372 Joule

Verschiedene Daten

Fe ¹⁾	=	0.15
delta L	=	

PATRONENLAGER MINI**Längen**

L1*	=	55.91
L2*	=	66.07
L3 ¹⁾	=	82.80

Stoßboden

R ¹⁾	=	1.04
R1	=	16.89
R2	=	
R3	=	
r	=	

Pulverkammer

E	=	
P1 ¹⁾	=	14.61
P2*	=	13.59

Schulterkonus

α	=	5°44'50"
S	=	191.28
r1 max	=	
r2	=	

Hülsenhals

H1*	=	12.57
H2 ¹⁾	=	12.50

Geschossübergang

G1 ^{1)*}	=	11.95
G ^{1)*}	=	10.60
α1	=	90°
h*	=	0.28
s	=	
i ¹⁾	=	0°49'58"
w	=	

Lauf

F ^{1)*}	=	11.65
Z ¹⁾	=	11.87

Züge

b	=	2.54
N	=	7
u	=	711.00
Q	=	108.57 mm ²

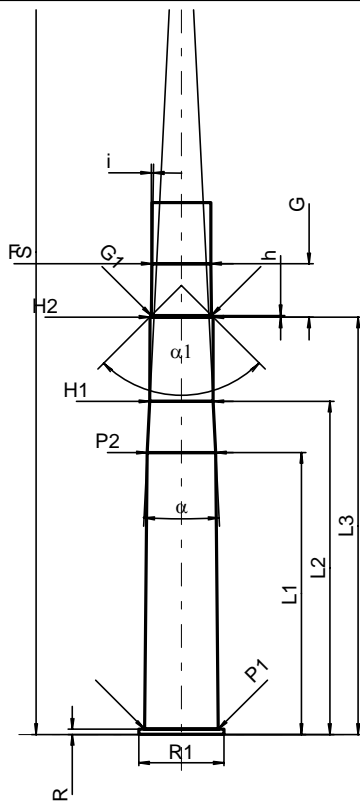

Maßstab 1:1.5

Maße in << mm >>
Maße und Toleranzen für Messläufe
siehe Anhang CR 1.

Bemerkungen: 1) Kontrolle aus Sicherheitsgründen
* Grundmaße