

C.I.P.**500 N. E. 3"**

Ursprungsland: GB

TAB. II

Datum 84-06-14

Revision 05-07-20

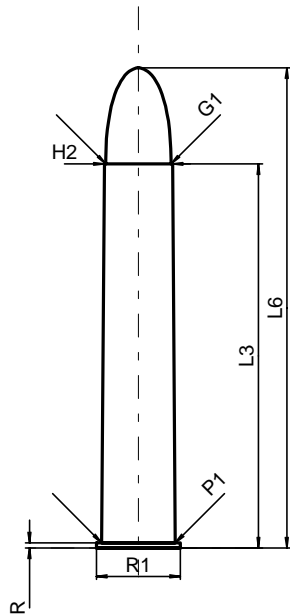
**PATRONE MAXI****Längen**

L1	=	
L2	=	
L3 ¹⁾	=	76.20
L4	=	
L5	=	
L6	=	95.25

Hülsenboden

R ¹⁾	=	1.02	-0.25
R1	=	16.64	
R3	=		
E	=		
E1	=		
e min	=		
δ	=		
f	=		
β	=		

Pulverkammer

P1	=	14.58
P2	=	

Schulterkonus

α	=	
S	=	
r1 min	=	
r2	=	

Hülsenhals

H1	=	
H2 ¹⁾	=	13.51

Geschoss

G1 ¹⁾	=	12.95
G2	=	
F	=	
L3+G ¹⁾	=	86.02

Drücke (Energien)**Mech. elektr. Wandler**

Pmax	=	2800 bar
PK	=	3220 bar
PE	=	3500 bar
M	=	25.00
EE	=	8400 Joule

Verschiedene Daten

Fe ¹⁾	=	0.15
delta L	=	

PATRONENLAGER MINI**Längen**

L1	=	
L2	=	
L3 ¹⁾	=	76.45

Stoßboden

R ¹⁾	=	1.04
R1	=	16.89
R2	=	
R3	=	
r	=	

Pulverkammer

E	=	
P1 ¹⁾	=	14.61
P2	=	

Schulterkonus

α	=	
S	=	
r1 max	=	
r2	=	

Hülsenhals

H1	=	
H2 ¹⁾	=	13.54

Geschossübergang

G1 ^{1)*}	=	13.00
G ^{1)*}	=	9.82
α1	=	90°
h*	=	0.27
s	=	
i ¹⁾	=	0°53'59"
w	=	

Lauf

F ^{1)*}	=	12.70
Z ¹⁾	=	13.00

Züge

b	=	3.61
N	=	7
u	=	381.00
Q	=	130.52 mm ²

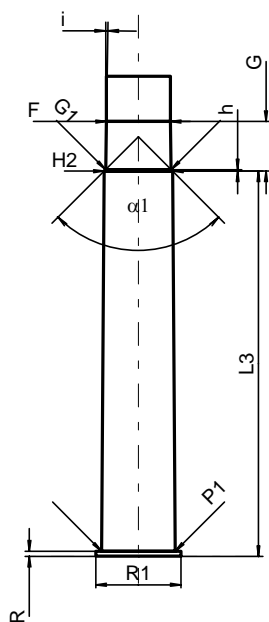

Maßstab 1:1.5

Maße in << mm >>
Maße und Toleranzen für Messläufe
siehe Anhang CR 1.

Bemerkungen: 1) Kontrolle aus Sicherheitsgründen
* Grundmaße