

**C.I.P.****45-70 Elko Mag.**

TAB. II

Datum 92-07-28

Revision 02-05-15

Ursprungsland: BE

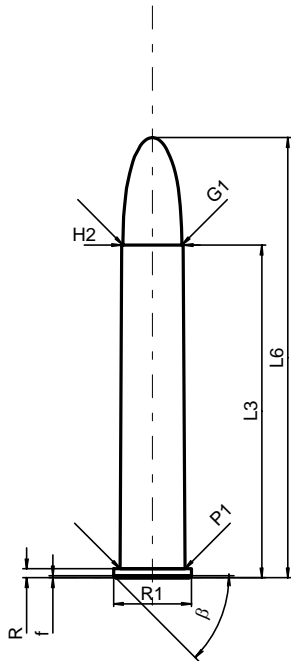
**PATRONE MAXI****Längen**

L1	=	
L2	=	
L3 <sup>1)</sup>	=	66.00
L4	=	
L5	=	
L6	=	87.30

**Hülsenboden**

R <sup>1)</sup>	=	1.78	-0.25
R1	=	15.44	
R3	=		
E	=		
E1	=		
e min	=		
delta	=		
f	=	0.38	
beta	=	45°	

**Pulverkammer**

P1	=	12.88
P2	=	

**Schulterkonus**

alpha	=	
S	=	
r1 min	=	
r2	=	

**Hülsenhals**

H1	=	
H2 <sup>1)</sup>	=	12.22

**Geschoss**

G1 <sup>1)</sup>	=	11.66
G2	=	
F	=	
L3+G <sup>1)</sup>	=	94.15

**Drücke (Energien)****Mech. elektr. Wandler**

Pmax	=	2950 bar
PK	=	3393 bar
PE	=	3690 bar
M	=	25.00
EE	=	6400 Joule

**Verschiedene Daten**

Fe <sup>1)</sup>	=	0.15
delta L	=	

**PATRONENLAGER MINI****Längen**

L1	=	
L2	=	
L3 <sup>1)</sup>	=	66.30

**Stoßboden**

R <sup>1)</sup>	=	1.78
R1	=	15.60
R2	=	
R3	=	
r	=	

**Pulverkammer**

E	=	
P1 <sup>1)</sup>	=	12.91
P2	=	

**Schulterkonus**

alpha	=	
S	=	
r1 max	=	
r2	=	

**Hülsenhals**

H1	=	
H2 <sup>1)</sup>	=	12.27

**Geschossübergang**

G1 <sup>1)*</sup>	=	11.91
G <sup>1)*</sup>	=	28.15
alpha1	=	90°
h*	=	0.18
s	=	
i <sup>1)</sup>	=	0°29'30"
w	=	

**Lauf**

F <sup>1)*</sup>	=	11.43
Z <sup>1)</sup>	=	11.58

**Züge**

b	=	3.58
N	=	6
u	=	508.00
Q	=	104.25 mm <sup>2</sup>

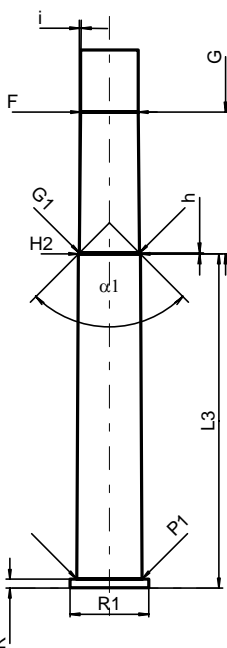

Maßstab 1:1.5

Maße in << mm >>  
Maße und Toleranzen für Messläufe  
siehe Anhang CR 1.

Bemerkungen: 1) Kontrolle aus Sicherheitsgründen  
\* Grundmaße