

C.I.P.**400 Purdey 3"**

TAB. II

Datum 84-06-14

Revision 07-05-14

Ursprungsland: GB

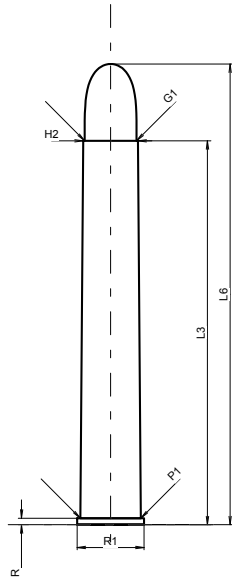
**PATRONE MAXI****Längen**

L1	=	
L2	=	
L3 ¹⁾	=	76.20
L4	=	
L5	=	
L6	=	91.44

Hülsenboden

R ¹⁾	=	1.32
R1	=	13.26
R3	=	
E	=	
E1	=	
e min	=	
δ	=	
f	=	
β	=	

Pulverkammer

P1	=	11.99
P2	=	

Schulterkonus

α	=	
S	=	
r1 min	=	
r2	=	

Hülsenhals

H1	=	
H2 ¹⁾	=	10.85

Geschoss

G1 ¹⁾	=	10.29
G2	=	
F	=	
L3+G ¹⁾	=	86.36

Drücke (Energien)**Mech. elektr. Wandler**

Pmax	=	2400 bar
PK	=	2760 bar
PE	=	3000 bar
M	=	25.00
EE	=	3300 Joule

Verschiedene Daten

Fe ¹⁾⁴⁾	=	0.15
delta L	=	

PATRONENLAGER MINI**Längen**

L1	=	
L2	=	
L3 ¹⁾	=	76.45

Stoßboden

R ¹⁾	=	1.35
R1	=	13.51
R2	=	
R3	=	
r	=	

Pulverkammer

E	=	
P1 ¹⁾	=	12.01
P2	=	

Schulterkonus

α	=	
S	=	
r1 max	=	
r2	=	

Hülsenhals

H1	=	
H2 ¹⁾	=	10.87

Geschossübergang

G1 ¹⁾ *	=	10.33
G ¹⁾	=	10.16
α1 *	=	90°
h	=	0.27
s	=	5.08
i ¹⁾ *	=	1°24'34"
w	=	

Lauf

F ¹⁾ *	=	10.08
Z ¹⁾	=	10.33

Züge

b	=	3.56
N	=	7
u	=	381.00
Q	=	82.98 mm ²

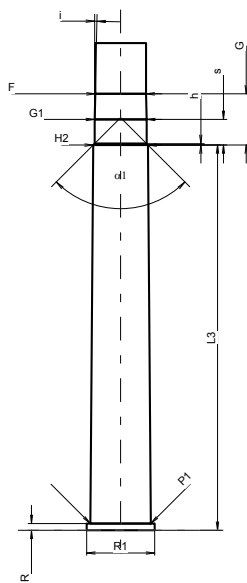

Maßstab 1:1.5

Maße in << mm >>
Maße und Toleranzen für Messläufe
siehe Anhang .

Bemerkungen: 1) Kontrolle aus Sicherheitsgründen
4) Verschlussabstand an Rand
* Grundmaße