

C.I.P.**40-82 Win.**

TAB. II

Datum 84-06-14

Revision 02-05-15

Ursprungsland: US

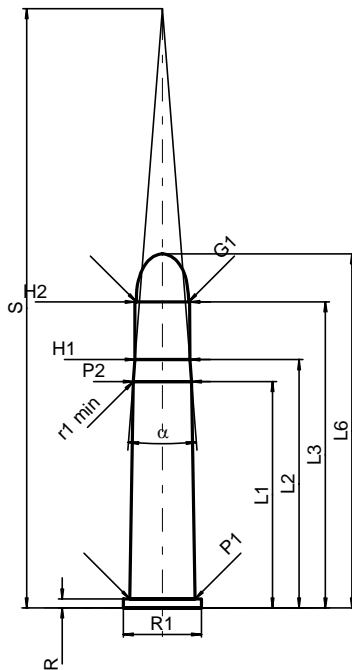
**PATRONE MAXI****Längen**

L1	=	44.91
L2	=	49.27
L3 ¹⁾	=	60.71
L4	=	
L5	=	
L6	=	70.23

Hülsenboden

R ¹⁾	=	1.78	-0.25
R1	=	15.49	
R3	=		
E	=		
E1	=		
e min	=		
delta	=		
f	=		
beta	=	45°	

Pulverkammer

P1	=	12.92
P2*	=	11.54

Schulterkonus

alpha*	=	8°55'
S*	=	118.91
r1 min	=	25.40
r2	=	

Hülsenhals

H1*	=	10.86
H2 ¹⁾	=	10.85

Geschoss

G1 ¹⁾	=	10.35
G2	=	
F	=	
L3+G ¹⁾	=	61.90

Drücke (Energien)**Mech. elektr. Wandler**

Pmax	=	1650 bar
PK	=	1898 bar
PE	=	2060 bar
M	=	25.00
EE	=	1590 Joule

Verschiedene Daten

Fe ¹⁾	=	0.15
delta L	=	

PATRONENLAGER MINI**Längen**

L1	=	44.83
L2	=	49.25
L3 ¹⁾	=	61.85

Stoßboden

R ¹⁾	=	1.78
R1	=	15.75
R2	=	
R3	=	
r	=	

Pulverkammer

E	=	
P1 ¹⁾	=	12.95
P2*	=	11.56

Schulterkonus

alpha*	=	8°55'
S*	=	118.96
r1 max	=	25.00
r2	=	

Hülsenhals

H1*	=	10.87
H2 ¹⁾	=	10.85

Geschossübergang

G1 ¹⁾ *	=	10.85
G ¹⁾	=	1.19
alpha1*	=	30°
h	=	
s	=	
i ¹⁾ *	=	15°
w	=	

Lauf

F ¹⁾ *	=	10.21
Z ¹⁾	=	10.36

Züge

b	=	3.19
N	=	6
u	=	406.00
Q	=	83.33 mm ²

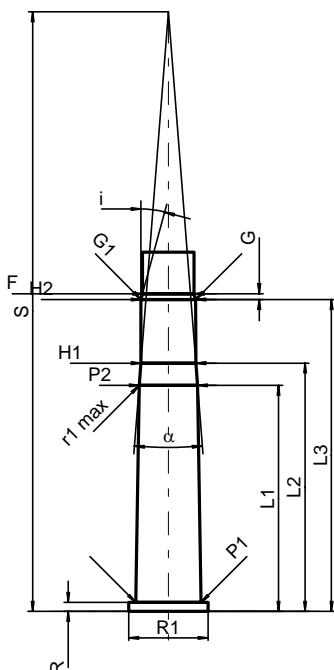

Maßstab 1:1.5

Maße in << mm >>
Maße und Toleranzen für Messläufe
siehe Anhang CR 1.

Bemerkungen: 1) Kontrolle aus Sicherheitsgründen
* Grundmaße