

C.I.P.**450 N.E. 3" 1/4**

TAB.

II

Datum

84-06-14

Revision

13-05-22

Ursprungsland: GB

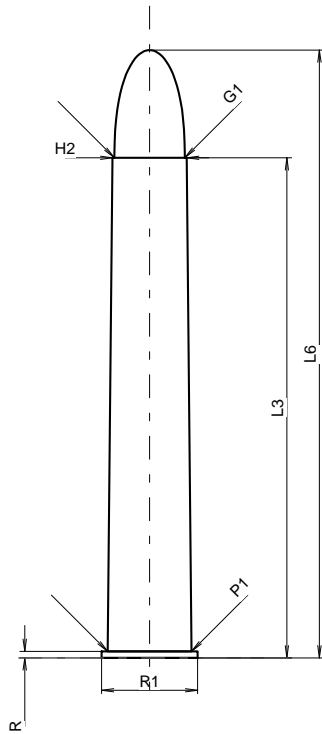
**PATRONE MAXI****Längen**

L1	=	
L2	=	
L3 ¹⁾	=	82.55
L4	=	
L5	=	
L6	=	100.33

Hülsenboden

R ¹⁾	=	1.07	-0.25
R1	=	15.85	
R3	=		
E	=		
E1	=		
e min	=		
δ	=		
f	=		
β	=		

Pulverkammer

P1	=	13.84
P2	=	

Schulterkonus

α	=	
S	=	
r1 min	=	
r2	=	

Hülsenhals

H1	=	
H2 ¹⁾	=	12.22

Geschoss

G1 ¹⁾	=	11.63
G2	=	
F	=	
L3+G ¹⁾	=	87.32

Drücke (Energien)**Mech. elektr. Wandler**

Pmax	=	3050 bar
PK	=	3508 bar
PE	=	3810 bar
M	=	25.00
EE	=	7000 Joule

Verschiedene Daten

Fe ¹⁾⁴⁾	=	0.15
delta L	=	

PATRONENLAGER MINI**Längen**

L1	=	
L2	=	
L3 ¹⁾	=	82.80

Stoßboden

R ¹⁾	=	1.09
R1	=	16.10
R2	=	
R3	=	
r	=	

Pulverkammer

E	=	
P1 ¹⁾	=	13.87
P2	=	

Schulterkonus

α	=	
S	=	
r1 max	=	
r2	=	

Hülsenhals

H1	=	
H2 ¹⁾	=	12.24

Geschossübergang

G1 ¹⁾ *	=	11.68
G ¹⁾ *	=	4.77
α1	=	90°
h *	=	0.28
s	=	
i ¹⁾	=	1°35'40"
w	=	

Lauf

F ¹⁾ *	=	11.43
Z ¹⁾	=	11.61

Züge

b	=	3.56
N	=	7
u	=	381.00
Q	=	104.89 mm ²

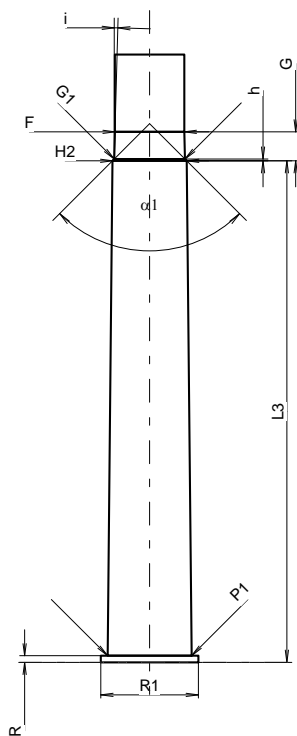

Maßstab 1:1.25

Maße in << mm >>
Maße und Toleranzen für Messläufe
siehe Anhang CR 1.

Bemerkungen: 1) Kontrolle aus Sicherheitsgründen
4) Verschlussabstand an Rand
* Grundmaße