

C.I.P.

450 N.E. 3" 1/4

Country of Origin: GB

TAB. II

Date 84-06-14

Revision 13-05-22

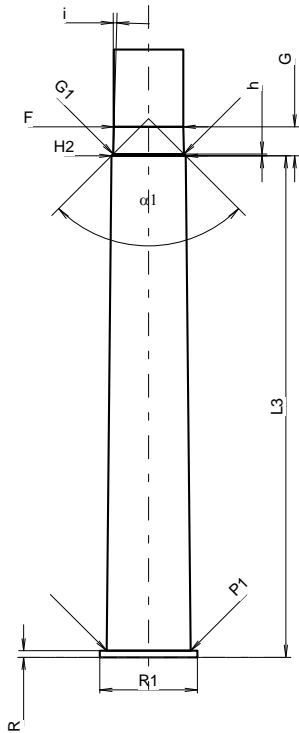
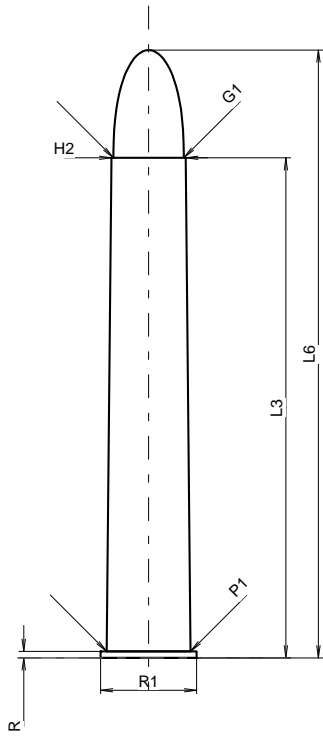

Scale 1:1.25

CARTRIDGE MAXI

Lengths

L1	=	
L2	=	
L3 ¹⁾	=	82.55
L4	=	
L5	=	
L6	=	100.33

Case Head

R ¹⁾	=	1.07	-0.25
R1	=	15.85	
R3	=		
E	=		
E1	=		
e min	=		
δ	=		
f	=		
β	=		

Powder Chamber

P1	=	13.84
P2	=	

Junction Cone

α	=	
S	=	
r1 min	=	
r2	=	

Collar

H1	=	
H2 ¹⁾	=	12.22

Projectile

G1 ¹⁾	=	11.63
G2	=	
F	=	
L3+G ¹⁾	=	87.32

Pressures (Energies)

Method Transducer

Pmax	=	3050 bar
PK	=	3508 bar
PE	=	3810 bar
M	=	25.00
EE	=	7000 Joule

Miscellaneous Dimensions

Fe ¹⁾⁴⁾	=	0.15
delta L	=	

CHAMBER MINI

Lengths

L1	=	
L2	=	
L3 ¹⁾	=	82.80

Breech

R ¹⁾	=	1.09
R1	=	16.10
R2	=	
R3	=	
r	=	

Powder Chamber

E	=	
P1 ¹⁾	=	13.87
P2	=	

Junction Cone

α	=	
S	=	
r1 max	=	
r2	=	

Collar

H1	=	
H2 ¹⁾	=	12.24

Commencement of Rifling

G1 ¹⁾ *	=	11.68
G ¹⁾ *	=	4.77
α_1	=	90°
h *	=	0.28
s	=	
i ¹⁾	=	1°35'40"
w	=	

Barrel

F ¹⁾ *	=	11.43
Z ¹⁾	=	11.61

Grooves

b	=	3.56
N	=	7
u	=	381.00
Q	=	104.89 mm ²

Notes: 1) Check for safety reasons
4) Headspace on Rim
* Basic dimensions

Dimensions in << mm >>
Dimensions and Tolerances for Proof Barrels
see Appendix CR 1.