

C.I.P.**45-110 Sharps 2"7/8**

TAB. II

Datum 17-05-17

Ursprungsland: US

Revision

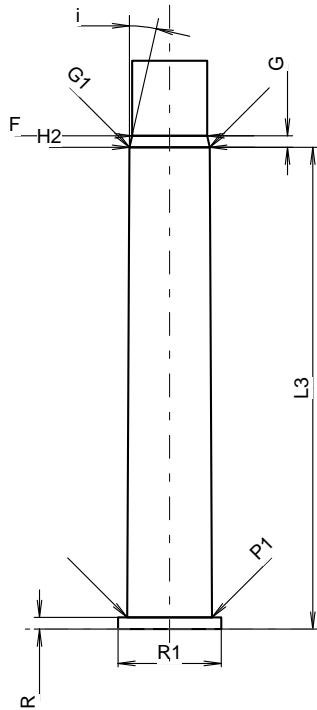
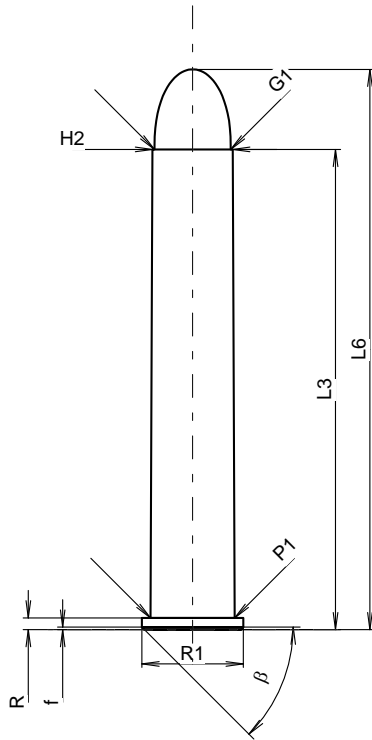

Maßstab 1:1.15

Maße in << mm >>
Maße und Toleranzen für Messläufe
siehe Anhang CR 1.

PATRONE MAXI**Längen**

L1	=	
L2	=	
L3 ¹⁾	=	73.11
L4	=	
L5	=	
L6	=	85.30

Hülsenboden

R ¹⁾	=	1.78	-0.25
R1	=	15.44	
R3	=		
E	=		
E1	=		
e min	=		
δ	=		
f	=	0.38	
β	=	45°	

Pulverkammer

P1	=	12.84
P2	=	

Schulterkonus

α	=	
S	=	
r1 min	=	
r2	=	

Hülsenhals

H1	=	
H2 ¹⁾	=	12.22

Geschoss

G1 ¹⁾	=	11.63
G2	=	
F	=	11.43
L3+G ¹⁾	=	74.86

Drücke (Energien)**Mech. elektr. Wandler**

Pmax	=	2550 bar
PK	=	2933 bar
PE	=	3188 bar
M	=	25.00
EE	=	5700 Joule

Verschiedene Daten

Fe ¹⁾⁴⁾	=	0.15
delta L	=	

PATRONENLAGER MINI**Längen**

L1	=	
L2	=	
L3 ¹⁾	=	73.35

Stoßboden

R ¹⁾	=	1.78
R1	=	15.70
R2	=	
R3	=	
r	=	

Pulverkammer

E	=	
P1 ¹⁾	=	12.91
P2	=	

Schulterkonus

α	=	
S	=	
r1 max	=	
r2	=	

Hülsenhals

H1	=	
H2 ¹⁾	=	12.22

Geschossübergang

G1 ¹⁾ *	=	12.22
G ¹⁾	=	1.75
α1	=	180°
h	=	
s	=	
i ¹⁾ *	=	12°43'10"
w	=	

Lauf

F ¹⁾ *	=	11.43
Z ¹⁾	=	11.58

Züge

b	=	3.58
N	=	6
u	=	508.00
Q	=	104.25 mm ²

Bemerkungen: 1) Kontrolle aus Sicherheitsgründen
4) Verschlussabstand an Rand
* Grundmaße