

**C.I.P.****356 Win.**

Ursprungsland: US

TAB. II

Datum 84-06-14

Revision 11-05-25

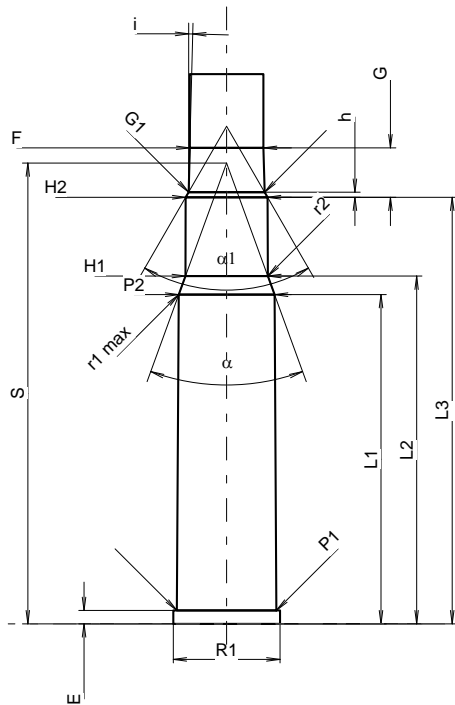
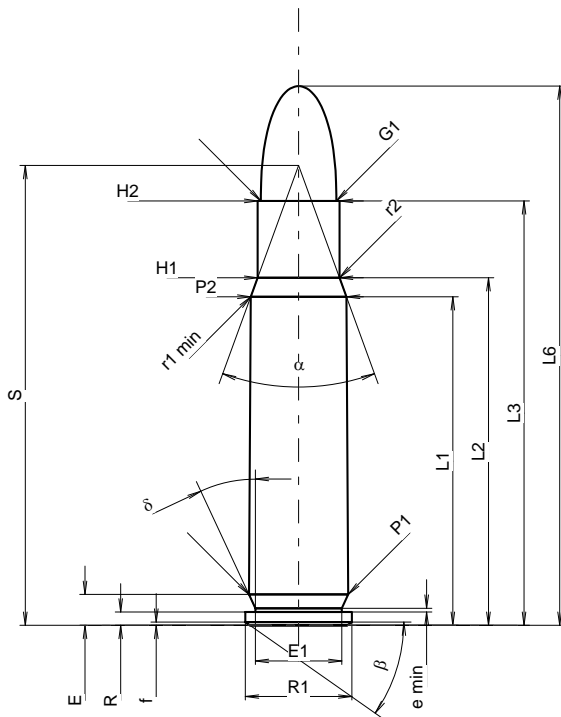

Maßstab 1.1:1

Maße in << mm >>  
Maße und Toleranzen für Messläufe  
siehe Anhang CR 1.

**PATRONE MAXI****Längen**

L1	=	39.62
L2	=	41.91
L3 <sup>1)</sup>	=	51.18
L4	=	
L5	=	
L6	=	65.02

**Hülsenboden**

R <sup>1)</sup>	=	1.60	-0.25
R1	=	12.85	
R3	=		
E	=	3.72	
E1	=	10.41	
e min	=	0.46	
delta	=	25°	
f	=	0.38	
beta	=	35°	

**Pulverkammer**

P1	=	11.96
P2 *	=	11.53

**Schulterkonus**

alpha *	=	40°
S *	=	55.45
r1 min	=	0.76
r2	=	2.54

**Hülsenhals**

H1 *	=	9.86
H2 <sup>1)</sup>	=	9.86

**Geschoss**

G1 <sup>1)</sup>	=	9.11
G2	=	
F	=	
L3+G <sup>1)</sup>	=	57.14

**Drücke (Energien)****Mech. elektr. Wandler**

Pmax	=	4150 bar
PK	=	4773 bar
PE	=	5190 bar
M	=	25.00
EE	=	3705 Joule

**Verschiedene Daten**

Fe <sup>1)3)</sup>	=	0.10
delta L	=	

**PATRONENLAGER MINI****Längen**

L1	=	39.69
L2	=	41.93
L3 <sup>1)</sup>	=	51.44

**Stoßboden**

R <sup>1)</sup>	=	1.60
R1	=	12.88
R2	=	
R3	=	
r	=	

**Pulverkammer**

E	=	1.60
P1 <sup>1)</sup>	=	12.01
P2 *	=	11.56

**Schulterkonus**

alpha *	=	40°
S *	=	55.57
r1 max	=	0.76
r2	=	2.79

**Hülsenhals**

H1 *	=	9.93
H2 <sup>1)</sup>	=	9.88

**Geschossübergang**

G1 <sup>1)</sup> *	=	9.17
G <sup>1)</sup>	=	5.96
alpha1 *	=	60°
h	=	0.61
s	=	
i <sup>1)</sup> *	=	1°30'
w	=	

**Lauf**

F <sup>1)</sup> *	=	8.89
Z <sup>1)</sup>	=	9.09

**Züge**

b	=	2.79
N	=	6
u	=	305.00
Q	=	63.77 mm <sup>2</sup>

Bemerkungen: 1) Kontrolle aus Sicherheitsgründen  
3) Verschlussabstand an Schulter  
\* Grundmaße