

C.I.P.**222 R Stief**

TAB.

II

Date

14-05-20

Country of Origin: DE

Revision

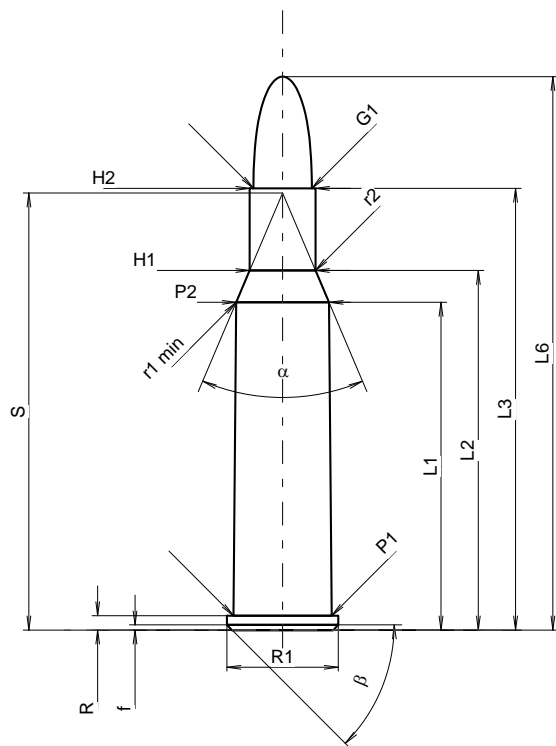
**CARTRIDGE MAXI****Lengths**

L1	=	32.04
L2	=	35.15
L3 ¹⁾	=	43.18
L4	=	
L5	=	
L6	=	54.10

Case Head

R ¹⁾	=	1.40	-0.25
R1	=	10.90	
R3	=		
E	=		
E1	=		
e min	=		
delta	=		
f	=	0.50	
beta	=	45°	

Powder Chamber

P1	=	9.59
P2 *	=	9.07

Junction Cone

alpha *	=	46°
S *	=	42.72
r1 min	=	0.64
r2	=	2.54

Collar

H1 *	=	6.43
H2 ¹⁾	=	6.43

Projectile

G1 ¹⁾	=	5.70
G2	=	
F	=	
L3+G ¹⁾	=	45.37

Pressures (Energies)**Method Transducer**

Pmax	=	3700 bar
PK	=	4255 bar
PE	=	4625 bar
M	=	25.00
EE	=	1600 Joule

Miscellaneous Dimensions

Fe ¹⁾⁴⁾	=	0.15
delta L	=	

CHAMBER MINI**Lengths**

L1	=	32.01
L2	=	35.10
L3 ¹⁾	=	43.48

Breech

R ¹⁾	=	1.40
R1	=	10.93
R2	=	
R3	=	
r	=	

Powder Chamber

E	=	
P1 ¹⁾	=	9.62
P2 *	=	9.10

Junction Cone

alpha *	=	46°
S *	=	42.73
r1 max	=	0.64
r2	=	3.18

Collar

H1 *	=	6.48
H2 ¹⁾	=	6.45

Commencement of Rifling

G1 ¹⁾ *	=	5.69
G ¹⁾	=	2.19
alpha l	=	90°
h	=	0.38
s *	=	1.02
i ¹⁾ *	=	3°10'47"
w	=	

Barrel

F ¹⁾ *	=	5.56
Z ¹⁾	=	5.69

Grooves

b	=	2.03
N	=	6
u	=	356.00
Q	=	25.09 mm ²

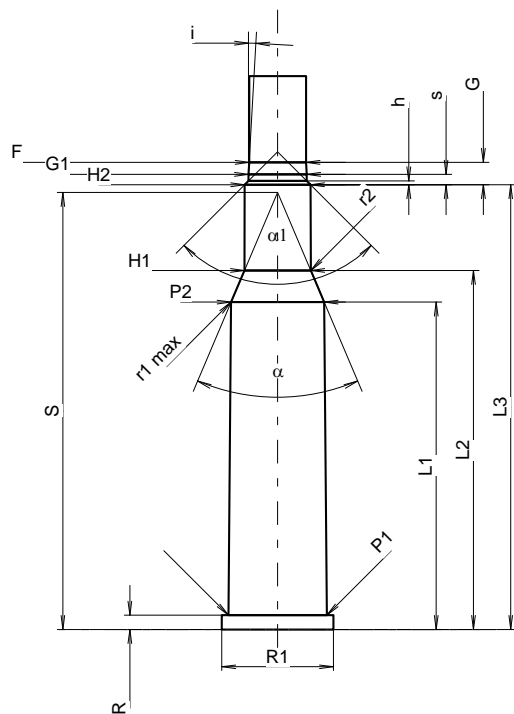

Scale 1.35:1

Dimensions in << mm >>
Dimensions and Tolerances for Proof Barrels
see Appendix CR1.

Notes: 1) Check for safety reasons
4) Headspace on Rim
* Basic dimensions