

C.I.P.

9,3 x 62

Pays d'origine: DE

TAB. I

Date 84-06-14

Révision 02-05-15

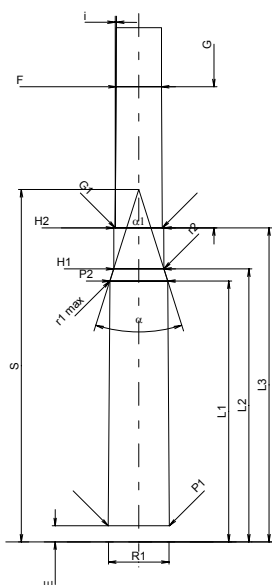
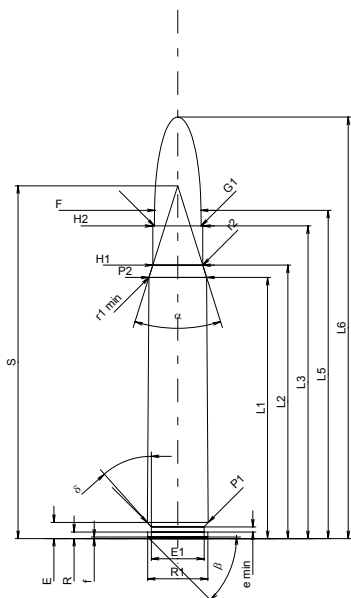

CARTOUCHE MAXI

Longueurs

L1 ¹⁾ *	=	51.79	-0.20
L2 ¹⁾ *	=	54.22	-0.20
L3 ¹⁾	=	62.00	
L4	=		
L5	=	65.10	
L6	=	83.60	

Culot

R	=	1.30	
R1	=	11.95	
R3	=		
E	=	3.20	
E1	=	10.50	
e min	=	1.00	
delta	=	41°37'48"	
f	=	0.30	
beta	=	45°	

Chambre à poudre

P1	=	12.10	
P2 ¹⁾ *	=	11.45	-0.20

Cône de raccordement

alpha	=	34°56'57"	
S	=	69.98	
r1 min	=	0.50	
r2	=	0.50	

Collet

H1 *	=	9.92	
H2 ¹⁾	=	9.92	

Projectile

G1 ¹⁾	=	9.30	
G2	=	9.30	
F	=		
L3+G ¹⁾	=	90.00	

Pressions (Énergies)

Méthode transducteur

Pmax	=	3900 bar	
PK	=	4485 bar	
PE	=	4875 bar	
M	=	25.00	
EE	=	5335 Joule	

Autres indications

Fe ¹⁾	=	0.10	
delta L	=		

CHAMBRE MINI

Longueurs

L1 *	=	51.75	
L2 *	=	54.17	
L3 ¹⁾	=	62.30	

Cuvette

R	=	1.30	
R1	=	12.00	
R2	=		
R3	=		
r	=		

Chambre à poudre

E	=	3.20	
P1 ¹⁾	=	12.13	
P2 *	=	11.48	

Cône de raccordement

alpha ¹⁾	=	35°05'06"	
S	=	69.91	
r1 max	=	0.50	
r2	=	0.50	

Collet

H1 *	=	9.95	
H2 ¹⁾	=	9.94	

Prise de rayures

G1 ¹⁾ *	=	9.35	
G ¹⁾ *	=	28.00	
alpha1	=	180°	
h	=		
s	=		
i ¹⁾	=	0°21'29"	
w	=		

Canon

F ¹⁾ *	=	9.00	
Z ¹⁾	=	9.28	

Rayures

b	=	4.60	
N	=	4	
u	=	360.00	
Q	=	66.32	mm ²

Échelle 1:1.5

Dimensions en << mm >>
Dimensions et tolérances pour les canons
d'épreuve: Voyez Annexe CR 1.

Notes: 1) A' contrôler pour la sécurité
* Dimensions de base