

C.I.P.

250 Savage

Country of Origin: US

TAB. I

Date 84-06-14

Revision 02-05-15

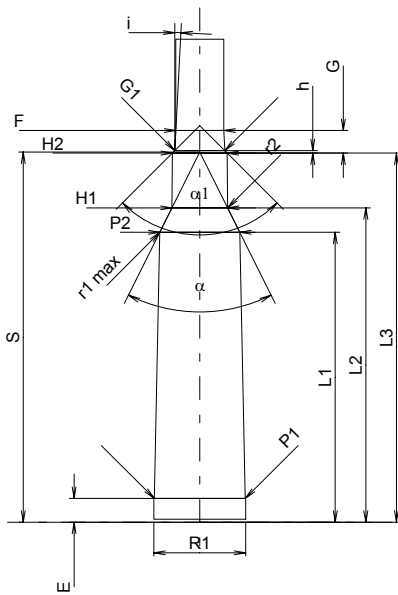
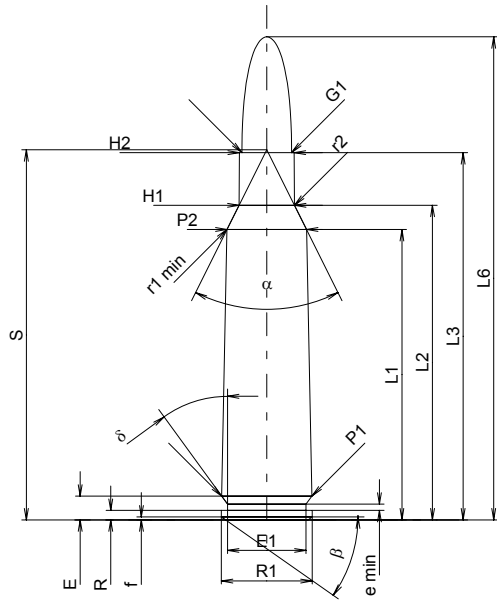

Scale 1:1

Dimensions in << mm >>
Dimensions and Tolerances for Proof Barrels
see Appendix CR 1.

CARTRIDGE MAXI

Lengths

L1 ¹⁾	=	38.40	-0.20
L2 ¹⁾	=	41.60	-0.20
L3 ¹⁾	=	48.56	
L4	=		
L5	=		
L6	=	63.88	

Case Head

R	=	1.24	
R1	=	12.01	
R3	=		
E	=	3.14	
E1	=	10.39	
e min	=	0.84	
delta	=	36°	
f	=	0.38	
beta	=	35°	

Powder Chamber

P1	=	11.93	
P2 ^{1)*}	=	10.52	-0.20

Junction Cone

alpha*	=	53°	
S*	=	48.95	
r1 min	=	2.54	
r2	=	2.54	

Collar

H1*	=	7.33	
H2 ¹⁾	=	7.25	

Projectile

G1 ¹⁾	=	6.55	
G2	=		
F	=		
L3+G ¹⁾	=	51.55	

Pressures (Energies)

Method Transducer

Pmax	=	3650 bar	
PK	=	4198 bar	
PE	=	4560 bar	
M	=	25.00	
EE	=	2900 Joule	

Miscellaneous Dimensions

Fe ¹⁾	=	0.15	
delta L	=		

CHAMBER MINI

Lengths

L1	=	38.36	
L2	=	41.58	
L3 ¹⁾	=	48.82	

Breech

R	=		
R1	=	12.14	
R2	=		
R3	=		
r	=		

Powder Chamber

E	=	3.14	
P1 ¹⁾	=	12.01	
P2*	=	10.56	

Junction Cone

alpha ^{1)*}	=	53°	
S*	=	48.95	
r1 max	=	2.54	
r2	=	2.54	

Collar

H1*	=	7.35	
H2 ¹⁾	=	7.26	

Commencement of Rifling

G1 ^{1)*}	=	6.63	
G ¹⁾	=	2.99	
alpha1*	=	90°	
h	=	0.32	
s	=		
i ^{1)*}	=	3°	
w	=		

Barrel

F ^{1)*}	=	6.35	
Z ¹⁾	=	6.53	

Grooves

b	=	2.24	
N	=	6	
u	=	356.00	
Q	=	32.90	mm ²

Notes: 1) Check for safety reasons
* Basic dimensions