

# C.I.P.

# 8 x 64

<b>TAB.</b>	<b>I</b>
<b>Date</b>	<b>84-06-14</b>
<b>Revision</b>	<b>02-05-15</b>

Country of Origin: DE

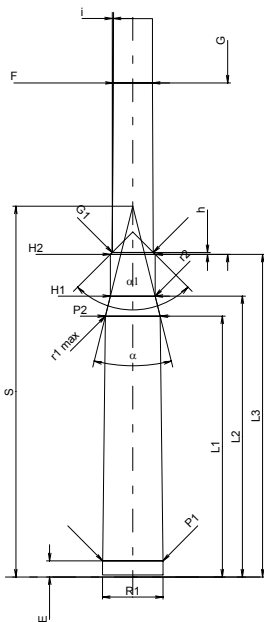
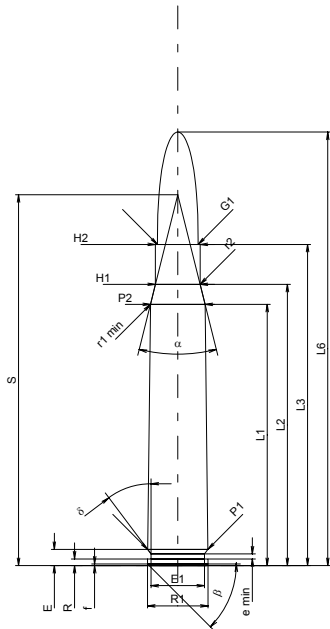

Scale 1:1.5

Dimensions in << mm >>  
Dimensions and Tolerances for Proof Barrels  
see Appendix CR 1.

### CARTRIDGE MAXI

#### Lengths

L1 <sup>1)</sup> *	=	51.80	-0.20
L2 <sup>1)</sup> *	=	55.79	-0.20
L3 <sup>1)</sup>	=	63.70	
L4	=		
L5	=		
L6	=	86.00	

#### Case Head

R	=	1.30
R1	=	12.00
R3	=	
E	=	3.20
E1	=	10.60
e min	=	1.00
delta	=	36°52'12"
f	=	0.30
beta	=	45°

#### Powder Chamber

P1	=	11.95	
P2 <sup>1)</sup> *	=	10.85	-0.20

#### Junction Cone

alpha	=	28°00'18"
S	=	73.55
r1 min	=	0.50
r2	=	0.50

#### Collar

H1 *	=	8.86
H2 <sup>1)</sup>	=	8.86

#### Projectile

G1 <sup>1)</sup>	=	8.09
G2	=	
F	=	
L3+G <sup>1)</sup>	=	97.70

#### Pressures (Energies)

##### Method Transducer

Pmax	=	4050 bar
PK	=	4658 bar
PE	=	5060 bar
M	=	25.00
EE	=	4375 Joule

#### Miscellaneous Dimensions

Fe <sup>1)</sup>	=	0.10
delta L	=	

### CHAMBER MINI

#### Lengths

L1 *	=	51.74
L2 *	=	55.73
L3 <sup>1)</sup>	=	64.00

#### Breech

R	=	1.30
R1	=	12.00
R2	=	
R3	=	
r	=	

#### Powder Chamber

E	=	3.20
P1 <sup>1)</sup>	=	11.96
P2 *	=	10.88

#### Junction Cone

alpha <sup>1)</sup>	=	28°00'18"
S	=	73.55
r1 max	=	0.50
r2	=	0.50

#### Collar

H1 *	=	8.89
H2 <sup>1)</sup>	=	8.88

#### Commencement of Rifling

G1 <sup>1)</sup> *	=	8.14
G <sup>1)</sup> *	=	34.00
alpha1	=	90°
h *	=	0.37
s	=	
i <sup>1)</sup>	=	0°17'21"
w	=	

#### Barrel

F <sup>1)</sup> *	=	7.80
Z <sup>1)</sup>	=	8.07

#### Grooves

b	=	4.40
N	=	4
u	=	240.00
Q	=	50.30 mm <sup>2</sup>

Notes: 1) Check for safety reasons  
\* Basic dimensions