

C.I.P.

8 x 51 (Mauser K)

Country of Origin: DE

TAB. I

Date 84-06-14

Revision 02-05-15

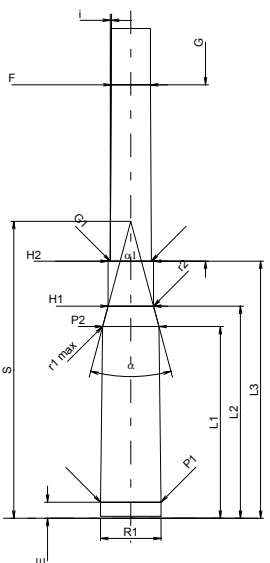
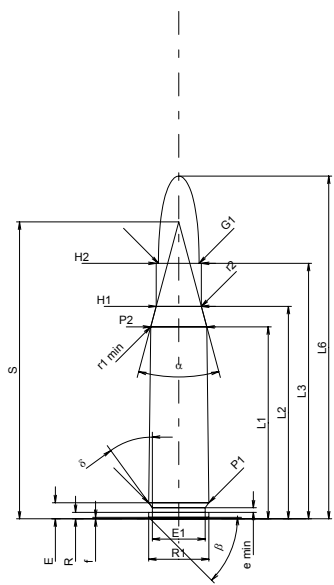

Scale 1:1.5

Dimensions in << mm >>
Dimensions and Tolerances for Proof Barrels
see Appendix CR 1.

CARTRIDGE MAXI

Lengths

L1 ¹⁾ *	=	38.09	-0.20
L2 ¹⁾ *	=	42.16	-0.20
L3 ¹⁾	=	50.70	
L4	=		
L5	=		
L6	=	68.00	

Case Head

R	=	1.30	
R1	=	11.95	
R3	=		
E	=	3.20	
E1	=	10.50	
e min	=	0.90	
delta	=	36°	
f	=	0.30	
beta	=	45°	

Powder Chamber

P1	=	11.95	
P2 ¹⁾ *	=	11.15	-0.20

Junction Cone

alpha	=	29°59'08"	
S	=	58.91	
r1 min	=	0.50	
r2	=	0.50	

Collar

H1 *	=	8.97	
H2 ¹⁾	=	8.97	

Projectile

G1 ¹⁾	=	8.07	
G2	=		
F	=		
L3+G ¹⁾	=	85.70	

Pressures (Energies)

Method Transducer

Pmax	=	3400 bar	
PK	=	3910 bar	
PE	=	4250 bar	
M	=	25.00	
EE	=	2635 Joule	

Miscellaneous Dimensions

Fe ¹⁾	=	0.15	
delta L	=		

CHAMBER MINI

Lengths

L1 *	=	38.04	
L2 *	=	42.09	
L3 ¹⁾	=	51.00	

Breech

R	=	1.30	
R1	=	12.00	
R2	=		
R3	=		
r	=		

Powder Chamber

E	=	3.20	
P1 ¹⁾	=	11.98	
P2 *	=	11.18	

Junction Cone

alpha ¹⁾	=	29°59'42"	
S	=	58.91	
r1 max	=	0.50	
r2	=	0.50	

Collar

H1 *	=	9.01	
H2 ¹⁾	=	9.00	

Commencement of Rifling

G1 ¹⁾ *	=	8.15	
G ¹⁾ *	=	35.00	
alpha1	=	180°	
h	=		
s	=		
i ¹⁾	=	0°17'11"	
w	=		

Barrel

F ¹⁾ *	=	7.80	
Z ¹⁾	=	8.07	

Grooves

b	=	4.40	
N	=	4	
u	=	240.00	
Q	=	50.30	mm ²

Notes: 1) Check for safety reasons
* Basic dimensions