

C.I.P.

416 Ruger

Country of Origin: US

TAB. I

Date 10-05-26

Revision

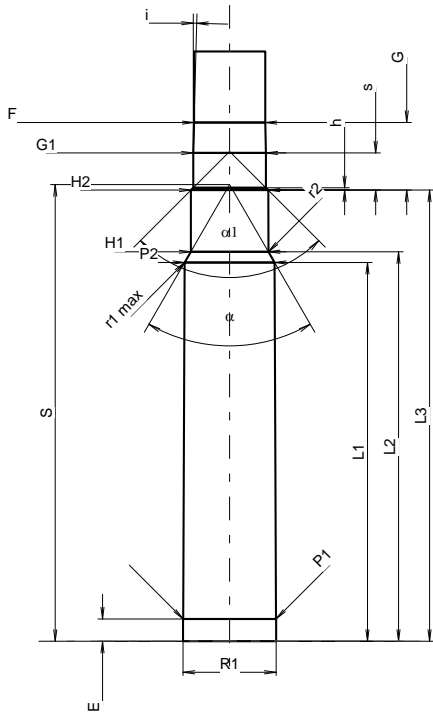
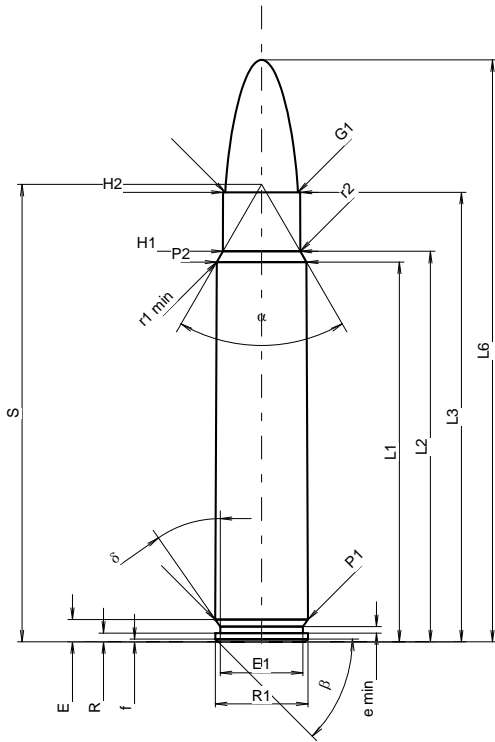

Scale 1:1.1

Dimensions in << mm >>
Dimensions and Tolerances for Proof Barrels
see Appendix CR 1.

CARTRIDGE MAXI

Lengths

L1 ¹⁾	=	55.37	-0.20
L2 ¹⁾	=	56.93	-0.20
L3 ¹⁾	=	65.53	
L4	=		
L5	=		
L6	=	84.84	

Case Head

R	=	1.27	
R1	=	13.51	
R3	=		
E	=	3.25	
E1	=	12.07	
e min	=	0.94	
delta	=	35°	
f	=	0.38	
beta	=	45°	

Powder Chamber

P1	=	13.52	
P2 ^{1)*}	=	13.08	-0.20

Junction Cone

alpha [*]	=	60°	
S [*]	=	66.69	
r1 min	=	0.76	
r2	=	3.18	

Collar

H1 [*]	=	11.28	
H2 ¹⁾	=	11.25	

Projectile

G1 ¹⁾	=	10.58	
G2	=		
F	=		
L3+G ¹⁾	=	75.38	

Pressures (Energies)

Method Transducer

Pmax	=	4300 bar	
PK	=	4945 bar	
PE	=	5375 bar	
M	=	25.00	
EE	=	7275 Joule	

Miscellaneous Dimensions

Fe ¹⁾³⁾	=	0.10	
delta L	=	0.12	

CHAMBER MINI

Lengths

L1	=	55.23	
L2	=	56.79	
L3 ¹⁾	=	65.78	

Breech

R	=		
R1	=	13.58	
R2	=		
R3	=		
r	=		

Powder Chamber

E	=	3.25	
P1 ¹⁾	=	13.54	
P2 [*]	=	13.10	

Junction Cone

alpha ^{1)*}	=	60°	
S [*]	=	66.58	
r1 max	=	0.76	
r2	=	3.18	

Collar

H1 [*]	=	11.30	
H2 ¹⁾	=	11.28	

Commencement of Rifling

G1 ^{1)*}	=	10.59	
G ¹⁾	=	9.85	
alpha1	=	90°	
h	=	0.34	
s [*]	=	5.42	
i ^{1)*}	=	1°30'	
w	=		

Barrel

F ^{1)*}	=	10.36	
Z ¹⁾	=	10.57	

Grooves

b	=	3.25	
N	=	6	
u	=	356.00	
Q	=	86.38	mm ²

Notes: 1) Check for safety reasons
3) Headspace on Shoulder
* Basic dimensions