

# C.I.P.

# 9,3 x 57

Country of Origin: DE

TAB. I

Date 07-05-14

Revision 11-05-25

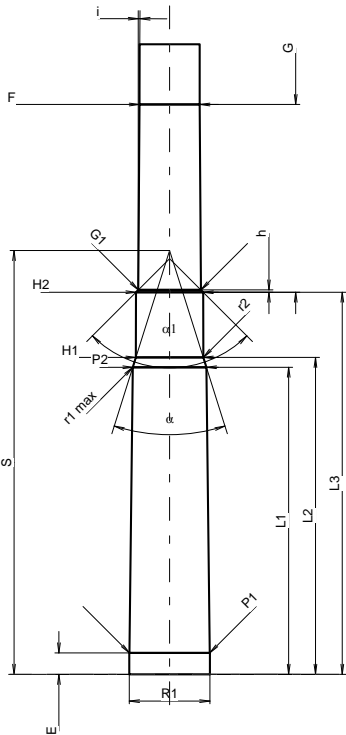
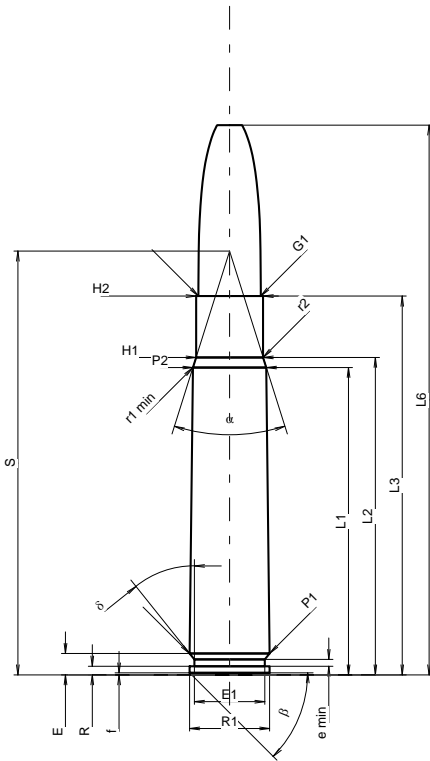

Scale 1:1.13

Dimensions in << mm >>  
Dimensions and Tolerances for Proof Barrels  
see Appendix CR 1.

### CARTRIDGE MAXI

#### Lengths

L1 <sup>1)</sup>	=	45.85	-0.20
L2 <sup>1)</sup>	=	47.36	-0.20
L3 <sup>1)</sup>	=	56.50	
L4	=		
L5	=		
L6	=	82.00	

#### Case Head

R	=	1.30	
R1	=	11.95	
R3	=		
E	=	3.20	
E1	=	10.50	
e min	=	1.00	
delta	=	38°39'36"	
f	=	0.30	
beta	=	45°	

#### Powder Chamber

P1	=	11.94	
P2 <sup>1)</sup> *	=	10.95	-0.20

#### Junction Cone

alpha *	=	35°	
S *	=	63.22	
r1 min	=	0.50	
r2	=	0.50	

#### Collar

H1 *	=	10.00	
H2 <sup>1)</sup>	=	10.00	

#### Projectile

G1 <sup>1)</sup>	=	9.30	
G2	=		
F	=		
L3+G <sup>1)</sup>	=	84.50	

#### Pressures (Energies)

##### Method Crusher

Pmax	=	3000 bar	
PK	=	3450 bar	
PE	=	3750 bar	
M	=	25.00	
EE	=	4250 Joule	

#### Miscellaneous Dimensions

Fe <sup>1)3)</sup>	=	0.15	
delta L	=		

### CHAMBER MINI

#### Lengths

L1	=	45.81	
L2	=	47.28	
L3 <sup>1)</sup>	=	57.00	

#### Breech

R	=	1.30	
R1	=	12.00	
R2	=		
R3	=		
r	=		

#### Powder Chamber

E	=	3.20	
P1 <sup>1)</sup>	=	11.97	
P2 *	=	10.98	

#### Junction Cone

alpha <sup>1)</sup> *	=	35°	
S *	=	63.22	
r1 max	=	0.50	
r2	=	0.50	

#### Collar

H1 *	=	10.05	
H2 <sup>1)</sup>	=	10.03	

#### Commencement of Rifling

G1 <sup>1)</sup> *	=	9.35	
G <sup>1)</sup>	=	28.00	
alpha1 <sup>1)</sup>	=	90°	
h	=	0.34	
s	=		
i <sup>1)</sup> *	=	0°21'45"	
w	=		

#### Barrel

F <sup>1)</sup> *	=	9.00	
Z <sup>1)</sup>	=	9.28	

#### Grooves

b	=	4.60	
N	=	4	
u	=	360.00	
Q	=	66.32	mm <sup>2</sup>

Notes: 1) Check for safety reasons  
3) Headspace on Shoulder  
\* Basic dimensions