

C.I.P.

8 x 60

Country of Origin: DE

TAB. I

Date 84-06-13

Revision 11-05-25

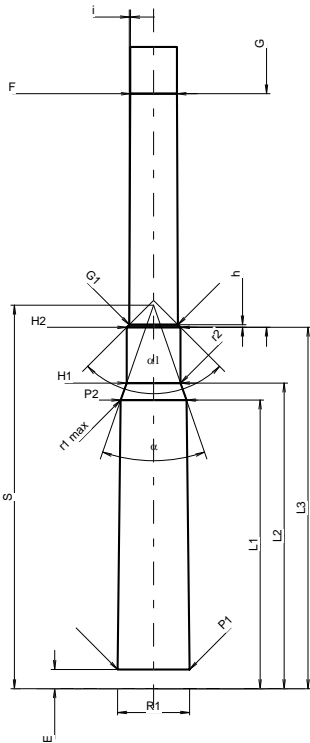
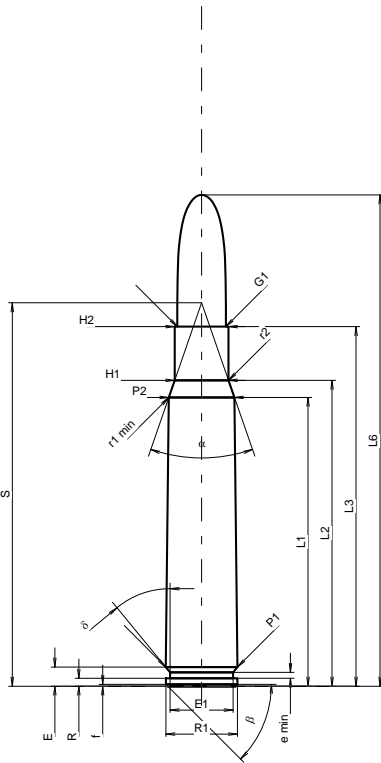

Scale 1:1.26

Dimensions in << mm >>
Dimensions and Tolerances for Proof Barrels
see Appendix CR 1.

CARTRIDGE MAXI

Lengths

L1 1)*	=	48.20	-0.20
L2 1)*	=	51.04	-0.20
L3 1)	=	60.00	
L4	=		
L5	=		
L6	=	82.00	

Case Head

R	=	1.30	
R1	=	11.95	
R3	=		
E	=	3.20	
E1	=	10.50	
e min	=	1.00	
delta	=	39°25'12"	
f	=	0.30	
beta	=	45°	

Powder Chamber

P1	=	11.98	
P2 1)*	=	10.95	-0.20

Junction Cone

alpha	=	38°15'22"	
S	=	63.99	
r1 min	=	0.50	
r2	=	0.50	

Collar

H1 *	=	8.98	
H2 1)	=	8.98	

Projectile

G1 1)	=	8.09	
G2	=		
F	=		
L3+G 1)	=	99.00	

Pressures (Energies)

Method Transducer

Pmax	=	4050 bar	
PK	=	4658 bar	
PE	=	5060 bar	
M	=	25.00	
EE	=	3900 Joule	

Miscellaneous Dimensions

Fe 1)3)	=	0.10	
delta L	=		

Notes: 1) Check for safety reasons
3) Headspace on Shoulder
* Basic dimensions

CHAMBER MINI

Lengths

L1 *	=	48.16	
L2 *	=	51.00	
L3 1)	=	60.30	

Breech

R	=	1.30	
R1	=	12.00	
R2	=		
R3	=		
r	=		

Powder Chamber

E	=	3.20	
P1 1)	=	12.01	
P2 *	=	10.98	

Junction Cone

alpha 1)	=	38°15'22"	
S	=	63.99	
r1 max	=	0.50	
r2	=	0.50	

Collar

H1 *	=	9.01	
H2 1)	=	9.00	

Commencement of Rifling

G1 1)*	=	8.12	
G 1)*	=	39.00	
alpha 1	=	90°	
h *	=	0.44	
s	=		
i 1)	=	0°14'16"	
w	=		

Barrel

F 1)*	=	7.80	
Z 1)	=	8.07	

Grooves

b	=	4.40	
N	=	4	
u	=	240.00	
Q	=	50.30	mm ²