

**C.I.P.****7-47 GS**

TAB.

I

Date

13-05-22

Revision

Country of Origin: IT

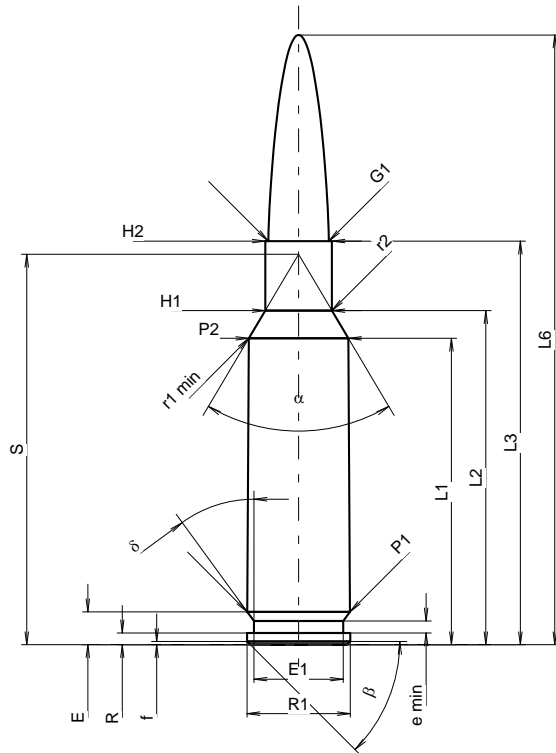
**CARTRIDGE MAXI****Lengths**

L1 <sup>1)</sup>	=	35.68	-0.20
L2 <sup>1)</sup>	=	38.90	-0.20
L3 <sup>1)</sup>	=	47.00	
L4	=		
L5	=		
L6	=	71.00	

**Case Head**

R	=	1.37	
R1	=	12.01	
R3	=		
E	=	3.84	
E1	=	10.39	
e min	=	1.40	
delta	=	36°	
f	=	0.38	
beta	=	45°	

**Powder Chamber**

P1	=	11.95	
P2 <sup>1)</sup> *	=	11.59	-0.20

**Junction Cone**

alpha *	=	61°21'	
S *	=	45.45	
r1 min	=	1.00	
r2	=	1.50	

**Collar**

H1 *	=	7.77	
H2 <sup>1)</sup>	=	7.77	

**Projectile**

G1 *	=	7.06	
G2	=		
F	=	6.86	
L3+G <sup>1)</sup>	=	52.57	

**Pressures (Energies)****Method Transducer**

Pmax	=	4350 bar	
PK	=	5003 bar	
PE	=	5438 bar	
M	=	25.00	
EE	=	3600 Joule	

**Miscellaneous Dimensions**

Fe <sup>1)3)</sup>	=	0.10	
delta L	=	0.09	

**CHAMBER MINI****Lengths**

L1	=	35.57	
L2	=	38.75	
L3 <sup>1)</sup>	=	47.26	

**Breech**

R	=		
R1	=	12.04	
R2	=		
R3	=		
r	=		

**Powder Chamber**

E	=	3.85	
P1 <sup>1)</sup>	=	11.99	
P2 *	=	11.63	

**Junction Cone**

alpha <sup>1)</sup> *	=	61°34'57"	
S *	=	45.33	
r1 max	=	0.75	
r2	=	1.75	

**Collar**

H1 *	=	7.84	
H2 <sup>1)</sup>	=	7.80	

**Commencement of Rifling**

G1 <sup>1)</sup> *	=	7.06	
G	=	5.57	
alpha l	=	90°	
h	=	0.37	
s *	=	1.64	
i <sup>1)</sup> *	=	1°27'27"	
w	=		

**Barrel**

F <sup>1)</sup> *	=	6.86	
Z <sup>1)</sup>	=	7.04	

**Grooves**

b	=	4.06	
N	=	4	
u	=	280.00	
Q	=	38.52	mm <sup>2</sup>

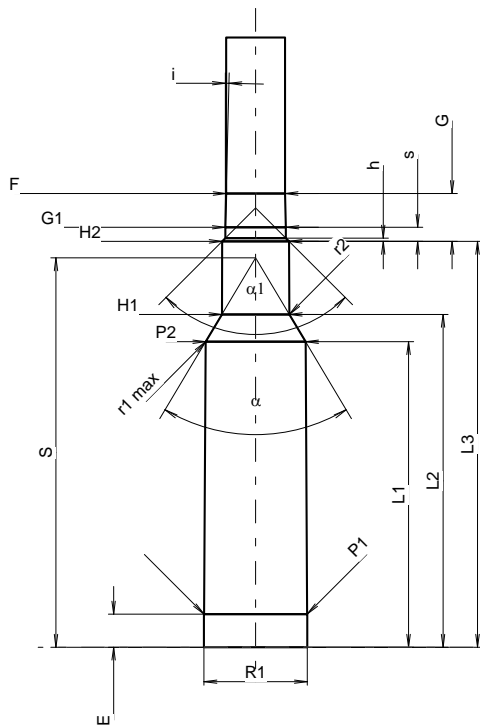

Scale 1.14:1

Dimensions in << mm >>  
Dimensions and Tolerances for Proof Barrels  
see Appendix CR 1.

Notes: 1) Check for safety reasons  
3) Headspace on Shoulder  
\* Basic dimensions